



## **OFF-LEASH DOG PARK**

### **Public Information Package 2**

---

<b>Information Package Contents:</b>	<b>Page No.</b>
<b>Written Submissions received from 2011 and 2015</b>	
• February 10, 2015 – Nevada Reddon	1
• September 16, 2014 – Patricia Marsh	3
• January 10, 2014 – Nancy Most	5
• May 29, 2014 – Nancy Most	6
• September 17, 2014 – Dana Howcroft	7
• December 7, 2014 - Jessica Everingham	8
• August 15, 2013 – Angela Cameron	9
• May 29, 2013 – Mark Ziegler	11
• January 15, 2013 – Kelli	12
• May 24, 2013 – Marcel Beauchemin	13
• May 16, 2013 – Angela and Dean Cameron	15
• September 2, 2013 – E.A. Anderson	21
• April 30, 2012 – Nancy Most	23
• January 27, 2011 – Cam Norris-Jones	24
• February 4, 2011 – Iain Pattison	25

*Please note that written and verbal submissions will become part of the public record. The relevant background documents may be viewed at the District of Sooke, 2205 Otter Point Road, Sooke, BC between the hours of 8:30 a.m. and 4:30 p.m., Monday to Friday, except statutory holidays or on the District of Sooke website [www.sooke.ca](http://www.sooke.ca)*

---

Mayor Maja Tait  
2205 Otter Point Road  
Sooke BC V9Z 1J2

February 10, 2015

Dear Mayor Tait and Sooke Council,

As an individual who has been a member of this community on and off for nearly 25 years I would like to express my feelings on something that I think the residents of Sooke need and I believe would want.

What I am talking about is a **fully fenced dog park** in Sooke. A large population of residents in Sooke dogs owners. Yes, there are many beautiful places like the Galloping Goose, or Whiffin Spit to take our pups and that is one of the reasons that I keep coming back here. In saying that having also an enclosed area ensures safety to those that need it, as well as opportunities for better socialization.

Off-leash dog areas with fencing provides a community setting in which people can gather and socialize and where they can observe the interaction of groups of dogs at play. Dog parks allow owners and their dogs to spend time together and offer dogs a space for play and companionship with others without the fear of a loved one running into traffic or into areas that are off limits.

In cities and towns with dog parks, they are among the most used park facilities. I saw this first hand when I moved to Calgary in May 2010 until May 2014. The amount of people and dogs that I would see at the numerous dog parks on any given day was wonderful. Even in the winter cold the park closest to us would be busy and on a sunny day the parking lot was overflowing. I meet some great people and their dogs but I also learned a great deal about my dogs, their behavior, and how to get the most out of my time out with them.

Not only would this be a great choice for the residents of Sooke and their "best friends" but it may also bring people from neighboring communities out to Sooke, who potentially will spend money even if only on a couple coffees.

I appreciate your time and thank you for your consideration to discuss this matter at a upcoming council meeting.

Sincerely,

Nevada Reddon

THANK YOU FROM BELLA AND MICAH :)



## Bonnie Sprinkling

---

**Subject:** RE: Whiffin Spit

**From:** Laura Hooper [<mailto:lhooper@sooke.ca>]  
**Sent:** September-16-14 11:21 AM  
**To:** Patricia Marsh  
**Cc:** Bonnie Sprinkling  
**Subject:** FW: Whiffin Spit

Hello Patricia,  
Please accept my apologies for the delayed response. The email was missed in my inbox.

Regarding the off leash dog park proposed for Ponds Park Corridor, the matter was referred back to the group advocating for the park by Council in May, 2013 to raise approximately half of the required funds to construct the park. As of February 5, 2014 the group had raised \$500 of the estimated \$7000. The report is attached.

Regarding your idea for dedicated play time at Whiffin Spit Park we are currently limited by the Community Parks Regulation. While your idea is a feasible one it would require a Council authorization to proceed. Staff recommends that you either appear as a delegation before Council or write a letter to Mayor and Council requesting this change to the Community Parks Regulation. Please contact Bonnie Sprinkling, copied on this email, should you wish to proceed.

Laura Hooper M. Sc. P. Ag.  
Parks and Environmental Services Coordinator

District of Sooke  
2205 Otter Point Road  
Sooke, British Columbia, V9Z 1J2  
Direct Phone: (250) 642-1639  
Cell: (250) 507-9944  
Main Office Phone: (250) 642-1634  
Fax: (250) 642-0541  
Email: [lhooper@sooke.ca](mailto:lhooper@sooke.ca)

THERE IS NO PLANET B.

---

**From:** Patricia Marsh  
**Sent:** Saturday, August 30, 2014 9:53 AM  
**To:** Info  
**Subject:** Whiffin Spit

We have been asking about the possibility of having a dog park in Sooke for years now. We will soon be on our third mayor with this issue. Can anyone tell me if this is indeed something that will happen, or for sure is not going to happen.

As you know, of the 13 municipalities, not ONE has a secure, fenced dog park. The closest one is in Duncan (and it is lovely).

Would there be any consideration to have one day/one-half day/a few hours of dedicated off-leash dogs at Whiffin Spit? Say, Wednesday mornings, dogs may be off leash. I'm talking about the big, goofy, loveable labs that don't come when they are called. Because they are not "under my control at all times", they are deprived of running free, playing with other dogs, and going into the water. My dogs are fun loving, agreeable, happy dogs, and we are responsible poop picker-uppers. Whiffin Spit is a perfect place. If it is a place "for everyone to use", then why can't we find a dedicated time to let them play?

Thoughts?

Patricia Marsh

**Laura Hooper**

---

**From:** Jack and Nancy Most [REDACTED]  
**Sent:** Friday, January 10, 2014 4:31 PM  
**To:** Laura Byrne  
**Subject:** Thank you

Hi Laura

I wanted to write to thank you so very much for the nice clean bathroom at Ed McGregor! It was clean and stocked.

Also, after deciding that you needed a koodos for that, I learned that there is a new garbage can at Church and the trail! Wonderful! Fabulous! No more taking other peoples dog pooh bags to the district garbage can.

Thank you for that too!

Just so you know, I'm pretty sure that having a dog park here isn't a good idea. I'd be happy to talk to you about it.

Have a nice w/e 😊

Nancy

---

 This email is free from viruses and malware because avast! Antivirus protection is active.

## Laura Hooper

---

**From:** Jack and Nancy Most [REDACTED]  
**Sent:** Thursday, May 29, 2014 11:45 AM  
**To:** Laura Hooper  
**Subject:** Thank You!

Hi Laura:

This is a heart felt thank you for being able to find someone to look after the parks. My neighbour said that she talked to you, and that you told her that the man you had hired quit.

The next thing we knew, the park behind our place was cut very well, as well as John Philips Memorial! My friends, who live on that park, talked to the fellow, and said that he was very nice.

The day after our park was cut, there was a mom with three little children out in the middle of it, flying kites. The folks throwing balls for their dogs were out again, because they wouldn't loose the balls!

Laura, we think that this park serves the public well, just the way it is, and needn't be fenced in.

My friend told me that there are \$ put aside for benches for John Phillips. Absolutely wonderful!! Also, I'm sure you are aware that we need good signage. We know of a sign carver who did the new neighbourhood at the end of Maple. Jack works with his partner. Anyway, we went down there to take a look, and were astounded by how breathtaking the two signs are. I can't explain them! Check them out!

Have a wonderful weekend Laura.

Nancy Most

Sept 17/2014

To whom it may concern: Re Dog Park

I am in support of a dog park in Sooke and would like you to consider allowing some space to be provided for this. At this time there is no place to take our dogs off leash and find this very difficult to exercise/ socialize our dogs. Please consider providing some space for an off-leash dog park. It is desperately needed here and would be beneficial for the many pet owners. I understand It's Over Rover has offered to fund the park and am sending this letter in support of this please consider this as it is desperately needed.

Thank you

Sincerely

Dana Howcroft

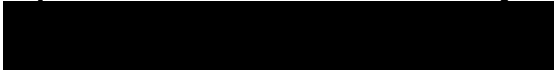

Sooke B.C.

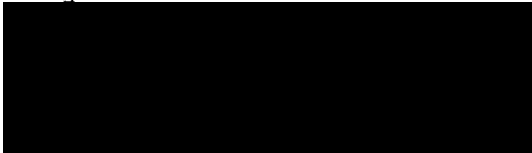



## Laura Hooper

---

**From:** Jessica Everingham [REDACTED]  
**Sent:** Sunday, December 07, 2014 1:34 PM  
**To:** Laura Hooper  
**Subject:** Dog park in Sooke

Hi there I messaged a Laura hooper I found on fb and then decided to search further and found this more official email so sorry for the double message if the other person is you ..lol! Anyhoo, Interested in getting some information about a possible dog park in Sooke or even east Sooke . I know some people tried to get one going but it fizzled out and I'm new to the scene so don't know details. All I know is there's tons of dogs living in Sooke and it would be in the towns best interest to have a dog park Why?

Because there's nothing better and safer than having properly socialized friendly dogs walking the streets that have gotten all their energy out for once because they get dog-dog play... Anyways let me know thanks hun! :) -Jessica everingham

[REDACTED]  
Sent from my iPhone

## Laura Hooper

---

**From:** Info  
**Sent:** Thursday, August 15, 2013 11:33 AM  
**To:** Bonnie Sprinkling  
**Cc:** Laura Byrne; Elisabeth Nelson  
**Subject:** FW: My letter to the Mayor and Council as to why I am against a Dog Park in Sooke

FYI

Teresa Burket  
District of Sooke  
2205 Otter Point Rd  
Sooke BC V9Z1J2  
250-642-1634

Please consider the environment before printing this e-mail

Rethink Reduce Reuse Repair Recycle

-----Original Message-----

**From:** Angela and Dean [REDACTED]  
**Sent:** Thursday, August 15, 2013 10:59 AM  
**To:** Info  
**Subject:** My letter to the Mayor and Council as to why I am against a Dog Park in Sooke

My name is Angela Cameron and I live at 6700 Acreman place. I am writing this letter to let Mayor Milne and Council know that I am against an off-leash dog park on the proposed site of "Pond Park Corridor".

My motivation in not wanting a dog park here is very clear to me that I live about 30 feet from the trail that runs along the length of the corridor where you want to put the dog park. I would like to ask everyone and would appreciate and honest answer, " would you like to live this close to a dog park"? I would also like to have you tell me how many dogs we are talking about. I have done my own research and made some local phone calls so I do know how many dogs we are talking about but I would like you to tell me. Now as for the research that you show in the frequently asked questions that compare Sooke to a "neighbourhood in San Francisco" Please let me know how a "city" like that which probably needs dog parks compares to a small "town" like Sooke. I feel you should do some more local research. For instance the house 3 doors down from where I live is now for rent as it has still not sold, that speaks to me more than research in a different country.

I would also like to know how you are going to enforce the noise bylaw #392, I believe. Having a dog park here is not only going to create a lot of noise, form the owners calling to their dogs and the dogs barking at the other dogs as well. There are also a number of dogs that live in the properties that back on to the proposed site, I can tell you that every time someone walks on the trail or rides a bike on the trail or pushes a stroller down the trail or plays with their dog in

the field, some of these residential dogs start barking. Some of the dogs even come out of their house using their doggie door as the owners are not home and continue to bark their little hearts out.

I would also like to let you know that my husband works night shift at the University of Victoria. He doesn't get home until 2:00 am or later some nights. Now having a dog park 30 feet from our house concerns me about him getting enough sleep. If he drives to work when he is sleep deprived and he is pulled over by the police they could say that he is impaired. That does not sit right with me at all.

When I was making my local phone calls doing my own research, I asked the Westshore City Hall office about their dog parks and I was told that they are putting in dogs parks because they have built so many Condos that they now have to provide the local residents with a place to exercise their dogs. I don't think that applies here in Sooke. As I understand it, Sooke is wanting an off-leash dog park because a specialty group of residents.

Now with the number of dogs that are licensed in Sooke I would like to know how you can possibly think that 14 parking spots in going to be enough. I don't think the area that you are proposing is even big enough for the number of licensed dogs in Sooke. Before this goes further into the planning with the "stake holders" I would like to inform council that I will be asking to have Acreman Place become a "Private Road" and to have residential parking only. If you look at Acreman Place you will see that all of our driveways at double. That is because we don't have a sidewalk, now if people were to park on the road and use the dog park that would mean that I would have to walk up the middle of the road, which not a safe.

Thank you for you time in reading this letter and I will wait to hear from you all.

Angela Cameron

## Laura Hooper

---

**From:** Bonnie [REDACTED]  
**Sent:** Wednesday, May 29, 2013 6:47 PM  
**To:** Laura Byrne  
**Subject:** Off-Leash Dog Park

Laura:

I am unable to make the public open house for an off-leash dog park this evening. I tried to locate the on-line feedback form with no luck. Please accept my input below.

1. My preference is to maintain the status quo in terms of dog access to public areas in Sooke. This option would only work if there were spot checks by a municipal by-law enforcement officer to ensure dog owners behave responsibly, by picking up their dogs' poop and controlling their dogs. Responsible dog owners should be encouraged to help with by-law observance by confronting non-responsible dog owners.
2. If creation of an off-leash park is deemed necessary by the District, I would be willing to accept this decision under three conditions: 1. park would be separated from recreational trails by fences; 2. grass would be cut regularly to make poop pick-up easier; and 3. waste disposal containers should be placed in the park and emptied regularly.

I live beside the proposed location for the off-leash park (between Townsend and Church). I am not a NIMBY person. If the above the three conditions were met, I would not oppose the park.

Respectfully,

Mark

Mark Ziegler  
[REDACTED]

Sooke

**Laura Hooper**

---

**From:** Info  
**Sent:** Tuesday, January 15, 2013 9:21 AM  
**To:** Laura Byrne  
**Subject:** FW: Safe Dog Areas

I believe this question goes to you, please let me know if it does not.

Thanks

Teresa Burket  
District of Sooke  
2205 Otter Point Rd  
Sooke BC V9Z1J2  
250-642-1634

Please consider the environment before printing this e-mail

Rethink Reduce Reuse Repair Recycle

-----Original Message-----

**From:** Rocket [REDACTED]  
**Sent:** Tuesday, January 15, 2013 2:30 AM  
**To:** Info  
**Subject:** Safe Dog Areas

Hi

Are there any fenced areas in Sooke where a responsible dog owner can take their dog to play fetch or frisbee? There are signs posted on all schools and baseball diamonds banning dogs from the fields when really, it should be signs that say 'irresponsible dog owners prohibited'.

The school field that I used to exercise my dogs is full of deer and goose poop. I don't think I've ever seen dog poop on that field which is a testament to the responsible people that used it before we were banned.

Edward Milne is a community school. Does that allow us on their fields to run our dogs?

Thanks

Kelli  
Sent from my iPad

## Laura Byrne

---

**From:** Gerard LeBlanc  
**Sent:** Friday, May 24, 2013 4:19 PM  
**To:** Laura Byrne  
**Cc:** Bonnie Sprinkling  
**Subject:** FW: Off-leash dog park/ Ponds park corridor

FYI

---

**From:** Marcel Beauchemin [REDACTED]  
**Sent:** Friday, May 24, 2013 4:18 PM  
**To:** Wendal Milne; Bev Berger; Herb Haldane; Rick Kasper; Kevin Pearson; Kerrie Reay; Maja Tait; Gord Howie; [bsprintling@sooke.ca](mailto:bsprintling@sooke.ca); Tina Hansen; Gerard LeBlanc; Elisabeth Nelson  
**Subject:** Off-leash dog park/ Ponds park corridor

Dear Sooke District Administrators,

As there are more veterinaries than medical doctors in the District of Sooke, we must have an appreciable canine population. For the last 9 or 10 years with the advent of the sanitary sewers, you have allowed detached houses, semi-detached houses and town-houses to be built on postage-stamp sized lots. These two factors alone would amply justify the construction of at least one off-leash dog park in the District.

A quick search of the internet shows that many Municipalities on the Island and in the rest of the Province have dedicated off-leash dog parks. All of these Municipalities share a common by-law. This by-law states that a dog must be leashed at all times except when in a fenced back yard or in a designated fenced-in off-leash dog park. All of these off-leash dog facilities also share a few features in common, they are all located far away from land zoned residential, they consist of a simple fenced-in field, they have limited day-time hours of operation and the only amenity offered consists of supplying doggy bags and a garbage can for the disposal of the used bags.

It is your responsibility as Administrators of the District to facilitate harmony between neighbours, help maintain as high a degree of quality of life for all the residents of the District and to help to maintain the property values of the residences in the District by writing, amending, implementing and enforcing by-laws. The intent of the existing dog barking by-law must be retained and taken into consideration in choosing a site or sites for off-leash dog parks. I suggest that you consider writing a by-law that would establish a buffer zone of at least 300 meters between an off-leash dog park and the nearest property zoned residential.

The Ponds Park Corridor is not suitable for an off-leash dog park for the following reasons:

- 1.- There is literally no parking.
- 2.- The Park is already used by a large number of school children, by young mothers with young children and by children playing.
- 3.- The Park abuts 31 residential properties and would impact at least 9 other properties, considering that each household has an average of three members, from 93 to 120 residents would have their quality of life negatively affected. The marketability and the market value of the abutting and of the near-by properties

would be negatively affected. No property owner should have to suffer a drop in the value of their house to accomodate an off-leash park. Dogs should be looked after but people deserve to come first.

4.- There also will be a sanitary problem as not all owners pick-up after their dog. Nobody should have to live next door to a dog bath-room.

With all the empty land in the District, you must certainly be able to find suitable locations for an off-leash dog park without negatively affecting the day-to-day welfare of the residents of the District and the value of their properties.

While we are on the subject of off-leash parks, what do you plan to do about our most beautiful park that also happens to be one of our tourist attractions? I am referring to Whiffen Spit Park which for all practical purposes is being used as an off-leash dog park. My wife and I used to love to go walking there. Lately, my wife has refused to go there because of the large numbers of off-leash dogs and also of on-leash dogs. People ought to deserve to come first.

Let's hope that you will take a decision that will take into consideration the well-being of the residents and not decrease their properties values.

Yours truly,

Marcel Beauchemin

District of Sooke

MAY 16 2013

Received

May 13, 2013

This letter is in response to the proposed "off leash dog park". As a resident of Acreman Place I am against a dog park in the area that you are proposing. There are a number of reasons that I don't want a dog park outside of my "front door". That being the first right there. Also there is no parking available for dog owners to park, because they will drive up here and not walk, just look at Wiffin Spit. I feel that the area would be better left as it is, as park land for everyone to enjoy. The trail that runs between Church and Townsend is always full of dog droppings and the signs on either end of the trail have a picture of a dog on a leash, owners just don't see this or care. I constantly have dogs barking that are just walking on the trail and running in to my yard, yes even in the back yard. As there owners call them and they just carry on chasing my cat. I'll say it again I don't want a dog park here.

Angela Cameron

*A Cameron*  
*Dean Cameron*

Attached is a copy of the agreement that we have with "Sooke" to keep this area as "parkland".



# FEEDBACK FORM



*This does not apply to us, how about a feed back form*

## OFF-LEASH DOG PARK

Ponds Park Corridor  
2276 Church Road

1. Have you ever been to an off leash dog park? *Circle one.*

Yes

No

I don't know

*to keep the "parkland"?*

2. Did you know Sooke does not have an off-leash dog park? *Circle one.*

Yes

No

3. Do you think Sooke could benefit from an area where dogs could safely play off-leash? *Circle one.*

Yes

No

I don't know

4. What features would you like to see at a dog park? *Circle all that apply.*

Waste stations & garbage receptacles

Shaded areas

Benches for people

People/dog water fountains

Restrooms

Lighting

Shelter from weather

Dog training/agility equipment

Rinse off area

Other: \_\_\_\_\_

5. What is most important to you for a safe dog park? *Circle all that apply.*

Cleanliness

Maintenance

Security

Park amenities-lights, water, etc.

Area/size

Hours of operation

Other: \_\_\_\_\_

6. Comments? *Use back of sheet if necessary.*

**Return to:**  
District of Sooke  
2205 Otter Point Road  
Sooke, British Columbia, V9Z 1J2  
Phone: (250) 642-1634  
Fax: (250) 642-0541  
Email: [info@sooke.ca](mailto:info@sooke.ca)  
Website: [www.sooke.ca](http://www.sooke.ca)



**TERMS OF INSTRUMENT PART 2****WHEREAS:**

- A. **WHEREAS** the Transferor is the owner in fee simple of that certain parcel of land and premises in the District of Sooke, Province of British Columbia, more particularly known and described as:

PID 023-908-360 Lot 3, Section 25, Sooke District, Plan VIP66027

(the "Lands")

- B. **AND WHEREAS** the Transferor has made an application to the Transferee to amend Sooke Land Use Bylaw 1992, Bylaw No. 2040 [together the "Zoning Bylaw"] by way of Zoning Amendment Bylaw No. 73, [the Official Community Plan Amendment Bylaw (1645-11)] and Bylaw No. 74, [Zoning Amendment Bylaw (2040-19)] (together the "Zoning Amendment Bylaw") to permit the development of the lands;
- C. **AND WHEREAS** the parties wish to restrict the subdivision and development of the lands as permitted by the Zoning Bylaw as amended by the Zoning Amendment Bylaw; and
- D. **AND WHEREAS** Section 219 of the *Land Title Act* R.S.B.C. 1996, c. 250 provides that the Transferor may grant to the Transferee a covenant in respect of the Lands even though the covenant is not annexed to land owned by the Transferee;

**NOW THEREFORE**, in consideration of the sum of ONE DOLLARS (\$1.00) paid by the Transferee to the Transferor, the receipt and sufficiency of which are hereby acknowledged by the Transferor, the Transferor agrees pursuant to Section 219 of the *Land Title Act* as follows:

The Lands shall not be subdivided, built upon, or used except in accordance with the following restrictions:

1. The Lands shall not be subdivided and/or built upon until the Transferee has approved the size and location of parklands to be dedicated by the Transferor as part of the subdivision process and for greater clarity, the parties acknowledge and agree that the size of the parkland will not be less than seventeen percent (17%) of the gross area of the Lands and the location of the parkland will substantially be as indicated as Areas D, E, and F as shown on a "Zone Areas" sketch attached hereto a Schedule A, except that reasonable minor adjustments in the boundaries of the park may be made to more efficiently subdivide the lands, provided the size of the parklands will not be less than seventeen (17%) of the gross area of the Lands.

2. The area indicated as Area I on Schedule A to this agreement shall not be subdivided, built upon, or used except as a septic field and for the purposes of on-site sewage disposal, and upon the installation of a community sewer system to and upon the lands, those lands identified as "Area I" shall be dedicated to the Transferee as Parklands.

3. The Lands shall not be subdivided and/or built upon until the Transferor has constructed a pathway substantially in the manner indicated on those parts of the Lands identified as Areas E, D, and F on Schedule A and to the satisfaction of the Transferee.

4. The Transferor agrees that the Transferee shall be under no obligation to issue any building permit in respect of any building or structure proposed to be constructed upon the Lands and the Approving Officer of the Transferee shall be under no obligation to approve any subdivision of the Lands until the Transferor has registered against the lands a building scheme that is approved by the Transferee.

5. Nothing in this Agreement exempts the Transferor or the Lands from the ordinary jurisdiction of the Transferee, its bylaws, permits, regulations and orders.

6. The covenants of the Transferor set out in the Agreement run with the Lands and any parcel or parcels into which they are consolidated or subdivided.

7. The Transferor will indemnify and save harmless the Transferee and its servants and agents against all losses, damages, costs and expenses, including solicitors' fees and other professional advisors, arising out of any breach, violation or non-performance of any terms, condition, covenant, or other provision of this Agreement.

8. No term, condition, covenant or other provision of this Agreement will be considered to have been waived by the Transferor unless the Transferee expresses the waiver in writing.

9. Any waiver by the Transferee of any term, condition, covenant, or other provision of this Agreement or any waiver by the Transferee of any breach, violation or non-performance of any term, condition, covenant or other provision of this Agreement does not constitute or will not be construed as a waiver of any further or other term, condition, covenant or other provision of the Agreement of any further or other breach, violation or non-performance of any term, condition, covenant or other provision of this Agreement.

10. If any part of this Agreement is found to be illegal or unenforceable, that part will be considered separate and severable and the remaining parts will not be affected thereby and will be enforceable to the fullest extent permitted by law.

11. Nothing contained or implied in this Agreement will prejudice or affect the rights, powers and remedies of the Transferee in the exercise of the Transferee's functions under any public or private statutes, regulations, bylaws, or orders or in equity, all of which may be fully and effectively exercised by the Transferee in relation to the Transferor or the lands as if this Agreement had not been made.

12. As evidence of their agreement to be bound by the terms of this instrument, the parties hereto have executed the Land Title Office Form C which is attached hereto and forms a part of this Agreement.

J.E. ANDERSON & ASSOC

250 727 3395

06/17 '02 03:41 NO.571 02/02

All dimensions are in meters  
All dimensions are approximately subject to  
verification by a legal survey



SCHEDULE "A"

Page 12

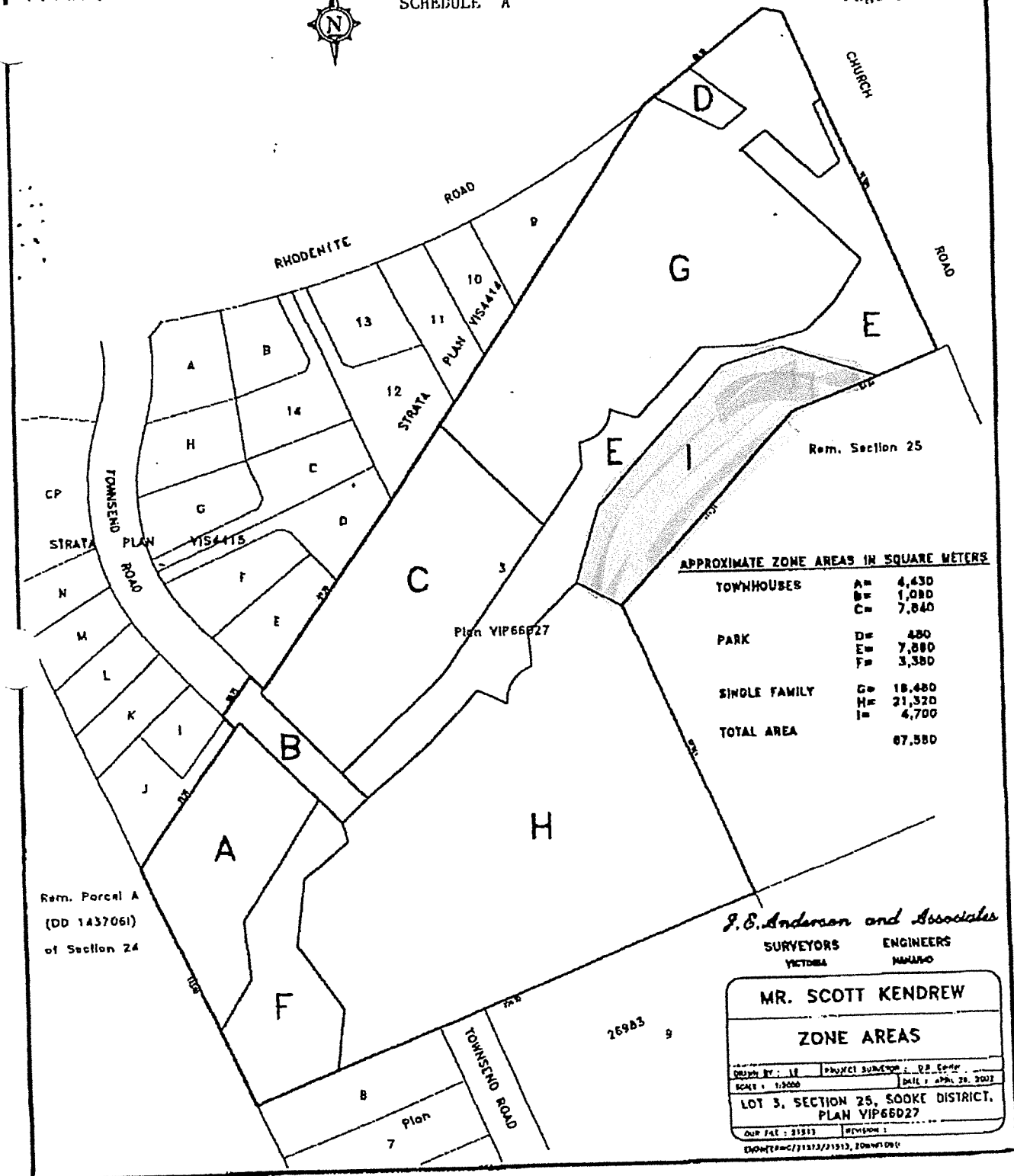

APPROXIMATE ZONE AREAS IN SQUARE METERS

TOWNHOUSES	A=	4,430
	B=	1,080
	C=	7,840
PARK	D=	480
	E=	7,880
	F=	3,380
SINGLE FAMILY	G=	18,480
	H=	21,320
	I=	4,700
TOTAL AREA		67,580

Rem. Parcel A  
(DD 1437061)  
of Section 24

J.E. Anderson and Associates  
SURVEYORS ENGINEERS  
VICTORIA NANAIMO

**MR. SCOTT KENDREW**

**ZONE AREAS**

Drawn by: J.E. Anderson Project Surveyor: J.E. Anderson  
 Scale: 1:1000 Date: April 28, 2002  
 LOT 3, SECTION 25, SOOKE DISTRICT,  
 PLAN VIP66027  
 Our File: 21913 Revision: 1  
 D:\WORK\2002\21913\21913\_TOWNSEND.DWG

END OF DOCUMENT

Mayor and Council.  
Sooke District Council

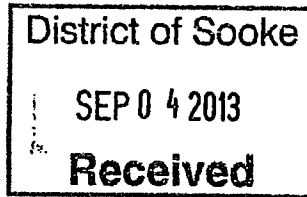

COPY

[REDACTED]  
Sooke.  
B.C. [REDACTED]



2 SEPT, 2013

Mayor Milne and Members of Council,

I am certain that the current two locally contentious issues (Bike Park sited in J.P.M.P and the proposed Off- Leash Dog Park at Ponds Place ) are causing Council some difficulty. Not wishing to add to the burden, I do wish to state my opinion, briefly, on both these troublesome situations.

**Bike Course in John Milne Memorial Park.**

I cannot understand why Sooke Bike Club and supporters are so adamant in choosing our public park for their proposed engineered Bike Training Course especially when the Seapark site has been upgraded by Council recently. Personally I am suspicious that the Club is not giving a clear vision of the size and complexity of their engineered course while concentrating on the health and social benefits engendered by such a course. Another concern is financing such a course, the cost of ongoing maintenance and repair, the policing of its use to prevent ant-social behaviour and of course, liability for damage to property and injury to users.

This large, open and essentially natural park is a valuable asset to our community and is enjoyed daily by all ages. Let us keep it undeveloped for all to enjoy and take pleasure in. Council, I believe, holds it in trust for the benefit of all its citizens.

**Off-Leash Dog-Run Park in Ponds Place.**

The existing small, linear open parkland at Ponds Place is used by many as a walkway to downtown, daily. Mother with strollers. Elementary and Middle School students, Senior citizens and dog owners walking their pets all enjoy the benefits of this park; it is a pleasant and safe access to J.P.M.P. and downtown businesses. Also it is part of the amenity for house-owners along its borders enjoyed now also by Townsend Place townhouse dwellers.

Changing its use to a Dog Park will completely ruin this existing open parkway and many will be forced to change walking routes even to traversing the dangerous Church Road with its lack of a proper sidewalk . Then there is the cost of maintenance and upkeep and no doubt clean-up by irresponsible pet

owners. Focusing on this small park, may bring many more dog owners from outside Sooke to utilize the facility, especially in summer months. Then there is the policing by Byelaw Officers dealing with probable noise and nuisance . More cost and liability for Council to cope with. A new and dedicated Free-Run Dog Park for the many pet owners in Sooke is no doubt advantageous to the community at large, but this small strip of parkland is totally unsuitable for such a purpose. Please choose another more suitable site.

I do sympathies with Council in trying to reach a decision suitable to most, if not all, citizens in such matters. However, I am certain Council will act responsibly and equitably in making necessary decisions for the community.

Thank you for considering my points of view,

A handwritten signature in cursive script that reads "E. A. Anderson". The signature is written in dark ink and is positioned above the printed name.

Mr. E. A. Anderson

**Laura Byrne**

---

**From:** Jack and Nancy Most [REDACTED]  
**ent:** Monday, April 30, 2012 4:36 PM  
**To:** Laura Byrne  
**Subject:** New dog park

Hi Laura:

Nancy here.

My neighbour, Bonnie and I were talking about the dog park behind us, and were wondering if you have a plan as to it's placing. We are hoping that the fence will be far enough away from the blackberries that people can still go there to pick them. I know that they are enjoyed by many people.

I look forward to hearing from you.

Cheers

Nancy



## Laura Byrne

---

**From:** Cam NorrisJones  
**nt:** Thursday, January 27, 2011 5:15 PM  
**To:** Laura Byrne  
**Subject:** Dog Park

John Phillips – at the top by Grant. I think that spot would work just dandy. Access from Otter Point Rd, parking area for 10 cars-ish. I've begun to really enjoy taking my dogs to the Park now that you had the trail put in. So, I think that is a good location for a lot of people.

**Cam Norris-Jones**  
**Firefighter**  
**Sooke Fire Rescue Service**  
**Office: 250.642.5422 ext. 672**  
**Fax: 250.642.3840**  
**Email: [cnorrisjones@sooke.ca](mailto:cnorrisjones@sooke.ca)**

**Laura Byrne**

---

**From:** [REDACTED]  
**ent:** Friday, February 04, 2011 6:39 PM  
**To:** Laura Byrne  
**Subject:** RE: Dog park

My only concern with the idea is also people who don't clean up after there dogs. as people are people and come up with the idea that they don't need to clean up after themselves.. i feel there should be some sort of regulating there to help with the cleaning so people don't lose the park.

ian

---

**From:** Laura Byrne [<mailto:lbyrne@sooke.ca>]  
**Sent:** Tuesday, February 01, 2011 0052Z  
**To:** [REDACTED]  
**Subject:** RE: Dog park

Ian,  
I apologise for the delay. Thank you for taking the time to bring this items to our attention. We are currently working with an interest group to determine if this is a viable option for our residents.

Best regards,  
Laura

Laura Byrne M.Sc. A.Ag.

District of Sooke  
2205 Otter Point Road  
Sooke, British Columbia, V9Z 1J2  
Direct Phone: (250) 642-1639  
Main Office Phone: (250) 642-1634  
Fax: (250) 642-0541  
Email: [lbyrne@sooke.ca](mailto:lbyrne@sooke.ca)

---

**From:** [REDACTED]  
**Sent:** November-30-10 6:12 PM  
**To:** Tina Hansen  
**Subject:** Dog park

I just moved to Sooke, and have found a disappointing feature to Sooke. There is no Off leash dog park. We regularly take our dogs for walks and are use to taking the dogs to a fenced in area that other people bring there dogs out to socialize. Is there any plans to bring an Off leash park that is fenced in so owners and dogs can have a change to socialize?

Iain Pattison