

# LITTLE RIVER MULTI-USE TRAIL DISTRICT OF SOOKE

SOOKE, BC

ISSUED FOR DISCUSSION

FEBRUARY 2024

Sheet List Table	
Sheet Number	Sheet Title
01	COVER SHEETS
02	GENERAL NOTES
03	STA 10+000 TO STA 10+130
04	STA 10+130 TO STA 10+210
05	STA 10+210 TO STA 10+310
06	STA 10+310 TO STA 10+410
07	STA 10+410 TO STA 10+500
08	STA 10+500 TO STA 10+600
09	STA 10+600 TO STA 10+730
10	STA 10+730 TO STA 10+780
11	STRUCTURAL NOTES
12	BRIDGE AND BOARDWALK - OVERALL ARRANGEMENT
13	BRIDGE - GENERAL ARRANGEMENT
14	BRIDGE - ABUTMENT SECTIONS & DETAILS
15	BRIDGE - SECTIONS & DETAILS
16	WEST BOARDWALK - GENERAL ARRANGEMENT
17	WEST BOARDWALK - ELEVATION
18	EAST BOARDWALK - GENERAL ARRANGEMENT
19	EAST BOARDWALK - ELEVATION
20	BOARDWALK - SECTIONS & DETAILS
21	PLANTING PLAN AND DETAIL

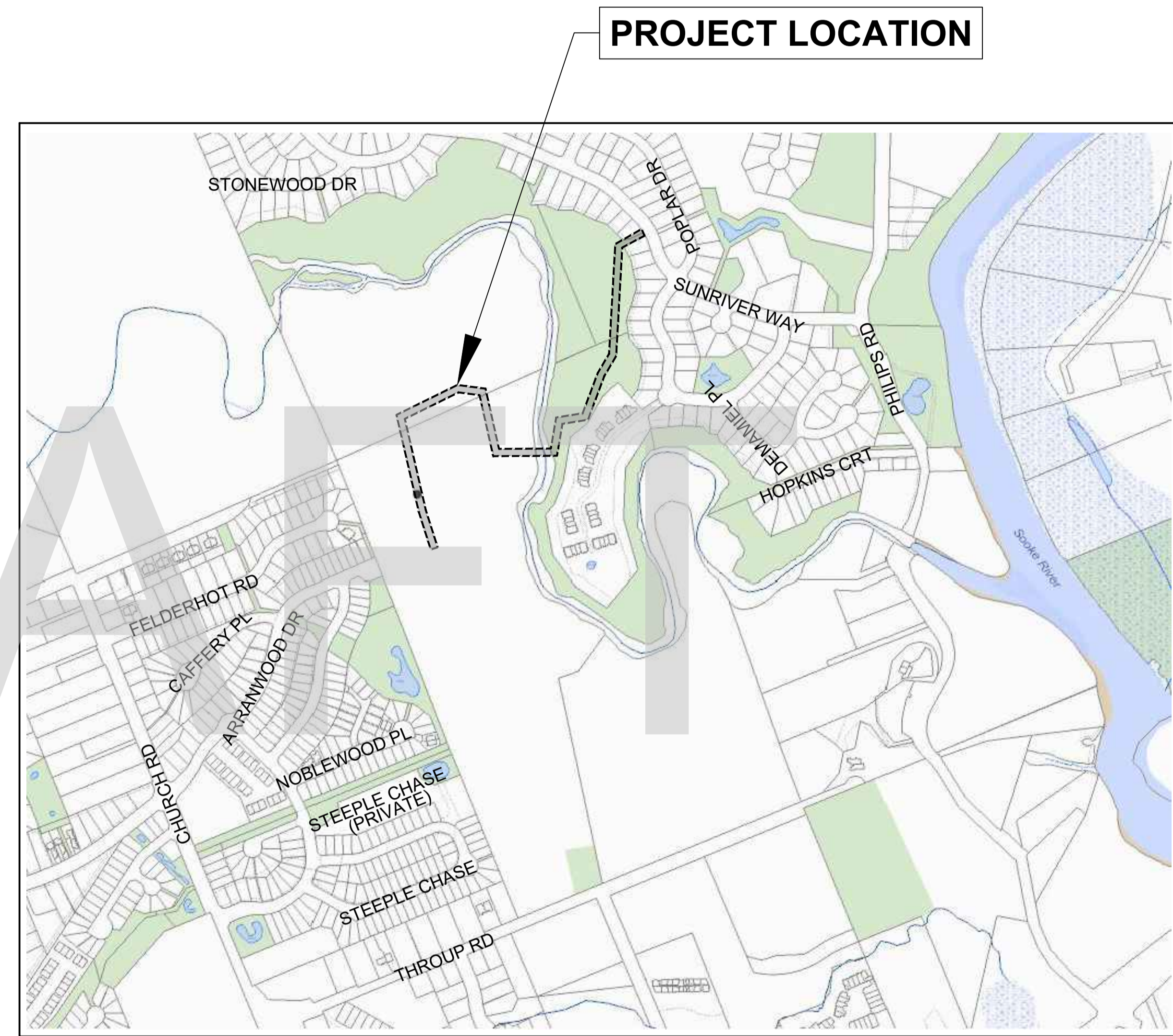

LOCATION PLAN



**GENERAL NOTES:**

- ALL CONSTRUCTION AND MATERIALS SHALL BE IN ACCORDANCE WITH:
  - THE MASTER MUNICIPAL CONSTRUCTION DOCUMENT AND STANDARD DETAIL DRAWINGS (MMCD 2009), PLATINUM EDITION AND DISTRICT OF SOOKE SUPPLEMENTARY SPECIFICATIONS AND DETAILED DRAWINGS UNLESS OTHERWISE NOTED;
  - APPLICABLE CONTRACT DOCUMENTS AND ALL SPECIFICATIONS REFERENCED THEREIN;
  - THE BRITISH COLUMBIA MINISTRY OF TRANSPORTATION AND INFRASTRUCTURES (BC MoTI) APPROVED PRODUCTS LIST, LATEST EDITION;
  - BC MoTI "BC TRAFFIC CONTROL MANUAL FOR WORK ON ROADWAYS", LATEST EDITION; AND
  - WORKSAFEBC, LATEST EDITION.
- ALL WORK SHALL BE COMPLETED ACCORDING TO THE BC LANDSCAPE STANDARD, LATEST EDITION, AND STANDARD CITY OF VICTORIA SPECIFICATIONS AND DETAILS UNLESS OTHERWISE APPROVED BY THE DISTRICT OF SOOKE.
- THIS DRAWING IS TO BE READ IN CONJUNCTION WITH THE WRITTEN SPECIFICATIONS, DRAWINGS, AND OTHER DETAILS AS ISSUED FOR THIS PROJECT.
- THE CONTRACTOR SHALL VISIT THE SITE TO CONFIRM SITE CONDITIONS PRIOR TO WORK. ANY DISCREPANCIES BETWEEN THE EXISTING SITE AND THE DRAWINGS ARE TO BE REPORTED TO THE CONSULTANT FOR CLARIFICATION PRIOR TO WORK.
- THE LIMITS OF THE WORK ARE TO BE CLEARLY UNDERSTOOD BY THE CONTRACTOR PRIOR TO ANY WORK TAKING PLACE ON SITE. THE CONTRACTOR IS TO CONTACT THE CONTRACT ADMINISTRATOR FOR CLARIFICATION IF REQUIRED.
- ALL ANCILLARY WORK NORMALLY ASSOCIATED WITH THE TYPE OF CONSTRUCTION INDICATED ON THE CONTRACT DRAWINGS AND DOCUMENTS SHALL BE DEEMED TO BE PART OF THE CONTRACT.
- ANY AMBIGUITY IN THIS DRAWING OR ACCOMPANYING DETAILS IS TO BE REPORTED TO THE CONTRACTOR ADMINISTRATOR. THE CONTRACTOR SHALL NOT PROCEED WITHOUT A CLEAR UNDERSTANDING OF THE WORK.
- LOCATIONS OF EXISTING UTILITIES AND SERVICES SHOWN ON THESE DRAWINGS ARE DERIVED FROM DISTRICT OF SOOKE BASE DRAWING, AGENCY AS-BUILTS, AND SURVEY INFORMATION. NO GUARANTEE IS MADE AS TO THEIR ACCURACY. THE CONTRACTOR IS TO COORDINATE WITH LOCAL UTILITY OPERATORS TO LOCATE OR ARRANGE THE LOCATE OF ALL EXISTING UTILITIES WITHIN THE LIMITS OF WORK PRIOR TO THE START OF CONSTRUCTION.
- THE CONTRACTOR SHALL CONTACT BC ONE CALL (1-800-474-6886) BC HYDRO, TELUS, SHAW CABLE, FORTIS GAS AND THE DISTRICT OF SOOKE FOR UNDERGROUND UTILITY LOCATIONS PRIOR TO CONSTRUCTION.
- THE CONTRACTOR IS RESPONSIBLE FOR THE HOARDING AND PROTECTION OF ALL RETAINED ELEMENTS WITHIN THE LIMITS OF WORK; INCLUDING BUT NOT LIMITED TO: EXISTING CURBS, CONCRETE, ASPHALT, GRANULAR OR OTHER SURFACES, LANDSCAPE AMENITIES AND LIVE LANDSCAPE MATERIAL, INCLUDING TREES, SHRUBS, GRASSES AND GROUNDCOVERS WITHIN, OR ADJACENT TO, THE LIMITS OF CONSTRUCTION.
- CAREFULLY RELOCATE EXISTING STREET FURNITURE, TRAFFIC SIGNS AND SITE FEATURES TO ACCOMMODATE CONSTRUCTION WORK, ALL EXISTING WORKS TO BE RETURNED TO AS FOUND OR BETTER CONDITION.
- THE CONTRACTOR IS RESPONSIBLE FOR THE HAULING OF ALL EXCESS MATERIALS OFF THE SITE.
- THE CONTRACTOR IS RESPONSIBLE FOR GENERAL SITE CLEAN UP.
- THE CONTRACTOR IS RESPONSIBLE FOR ANY DAMAGE TO LANDSCAPED AREAS AND MUST MAKE ALL NECESSARY RESTORATIONS AND REPAIRS.
- THE CONTRACTOR SHALL BE SOLELY RESPONSIBLE FOR CONSTRUCTION MEANS, METHODS, TECHNIQUES, SEQUENCES AND PROCEDURES AND FOR COORDINATION OF THE VARIOUS PARTS OF THE WORK.
- THE CONTRACTOR TO COORDINATE AND BEAR ALL COSTS FOR MATERIAL TESTING, SUCH AS CONCRETE COMPRESSION STRENGTH, GRANULAR COMPACTION AND ASPHALT DENSITY TESTS. RESULTS TO BE PROVIDED TO CONTRACT ADMINISTRATOR FOR REVIEW.

**ENVIRONMENTAL NOTES:**

- AVOID EARTH-DISTURBING ACTIVITIES DURING SUBSTANTIAL RAIN EVENTS.
- THE CONTRACTOR SHOULD AVOID STOCKPILING SOILS, SANDS AND OTHER ERODIBLE MATERIALS ONSITE WHERE POSSIBLE. IT IS PREFERABLE TO "HOT-LOAD" SPOIL DIRECTLY INTO TRUCKS FOR OFFSITE DISPOSAL. IF TEMPORARY WASTE OR SOIL STOCKPILES ARE NECESSARY, THE CONTRACTOR SHALL ENSURE THEY ARE FULLY COVERED WITH POLYETHYLENE DRAWING OR TARP AND WEIGHTED WITH SANDBAGS.
- TRACKING OF SEDIMENT, SOIL AND/OR ROADBASE FROM WORKSITE TO NEARBY VEHICLE TRAVEL LANES MUST BE PREVENTED.
- ENTRY-WAYS TO ADJACENT ROADS MUST BE SWEEPED CLEAN OF SOIL, LOOSE ROAD BASE, EARTH AND SEDIMENT. MECHANICAL SWEEPING IS PREFERRED TO MANUAL SWEEPING. HOWEVER, FREQUENT HAND SWEEPING IS PREFERABLY TO ONCE DAILY MECHANICAL SWEEPING.
- THE CONTRACTOR IS RESPONSIBLE FOR ENSURING THAT NO SEDIMENT OR SEDIMENT LADEN WATER IS DISCHARGED FROM THE WORKS TO ANY WATERCOURSES.
- AN EMERGENCY SPILL KIT WILL BE KEPT ONSITE AT ALL TIMES THE CONTRACTOR IS OPERATING. SPILL KITS MUST INCLUDE BOOMS, SPILL PADS, GLOVES, AND RUN-OFF BARRIERS. A SPILL KIT WITH AT LEAST 125 LITRES ABSORBENCY IS RECOMMENDED. A PRATICAL NUMBER SANDBAGS AND A SUPPLY OF SAND MUST BE KEPT ONSITE.
- IT IS THE CONTRACTOR'S RESPONSIBILITY TO DEVELOP A SPILL RESPONSE PLAN THAT PROVIDES WRITTEN SAFE WORK PROCEDURES IN THE EVENT OF A SPILL.
- THE CONTRACTOR IS TO DISPOSE OF CHLORINATED WATER AT AN APPROVED LOCATION ONLY AFTER APPROPRIATE TREATMENT WITH SODIUM THIOSULPHATE. AT NO TIME WILL THE CONTRACTOR DISCHARGE CHLORINATED WATER DIRECTLY TO A CATCHBASIN, CREEK, DITCH OR SWALE.
- THE CONTRACTOR IS TO OBTAIN OWNER'S APPROVAL PRIOR TO DISCHARGING FLUSHING WATER OR DISINFECTION WATER TO SANITARY SEWER MANHOLES.

DRAFT

**LEGEND**

**LINETYPES**

PROPOSED	EXISTING	DESCRIPTION
		RIGHT OF WAY
		CENTER LINE
		WATER MAIN
		WATER SERVICE
		STORM MAIN
		STORM SERVICE
		CB / DRAINAGE LEAD
		STREAM / CREEK / DITCH
		SANITARY SEWER MAIN
		SANITARY SERVICE
		ELECTRICAL
		CABLE
		NATURAL GAS
		CHAINLINK FENCE
		RETAINING WALL
		EDGE OF GRAVEL ROAD
		BOTTOM OF BANK
		TOP OF BANK
		EDGE OF PAVEMENT

**SYMBOLS**

PROPOSED	EXISTING	DESCRIPTION	PROPOSED	EXISTING	DESCRIPTION
		WATER VALVE AIR			STORM CATCHBASIN DOUBLE
		WATER VALVE			STORM CATCHBASIN
		WATER BEND			STORM CULVERT / HEADWALL
		WATER TEE			STORM LAWN DRAIN
		WATER CROSS			STORM MANHOLE
		WATER HYDRANT			SANITARY MANHOLE
		WATER REDUCER			GUY WIRE
		WATER ROBAR			TELUS MANHOLE
		WATER THRUST BLOCK			POLE
		WATER SERVICE			SIGN
		WATER BLOWOFF			STREETLIGHT
		WATER CAP			TREE
		WATER METER			JUNCTION BOX
		WATER HUB FLANGE			ELECTRICAL BOX

File: C:\Projects\33000\33549\_DOS\_DOS\_Little\_River\_Pel\_Crossing\02\_CADD\20\_Drafting\20\_Production\33549\_SH\_COVER.dwg

PLOT DATE: February 20, 2024			
REV NO.	REVISION DESCRIPTION	DATE	APP'R'D
A	ISSUED FOR REGULATORY APPROVAL	2023.12.13	AA IM
B	DETAILED DESIGN	2024.02.16	AA IM
C	ISSUED FOR DISCUSSION	2024.04.08	AA IM

**GENERAL NOTES**



1051 Vancouver St, Victoria, BC V8V 3K3  
T: (250)961-3230 F: (604)629-5756

ISSUED FOR DISCUSSION DESIGN NO.

33549

SCALE	1:250	CREATION DATE	2023/03/01	DWG. NO.	02
DRAWN BY	AA	DESIGN BY	KJ	OF	21
CHECKED BY	BRR	APPROVED BY	AA	REV.	C

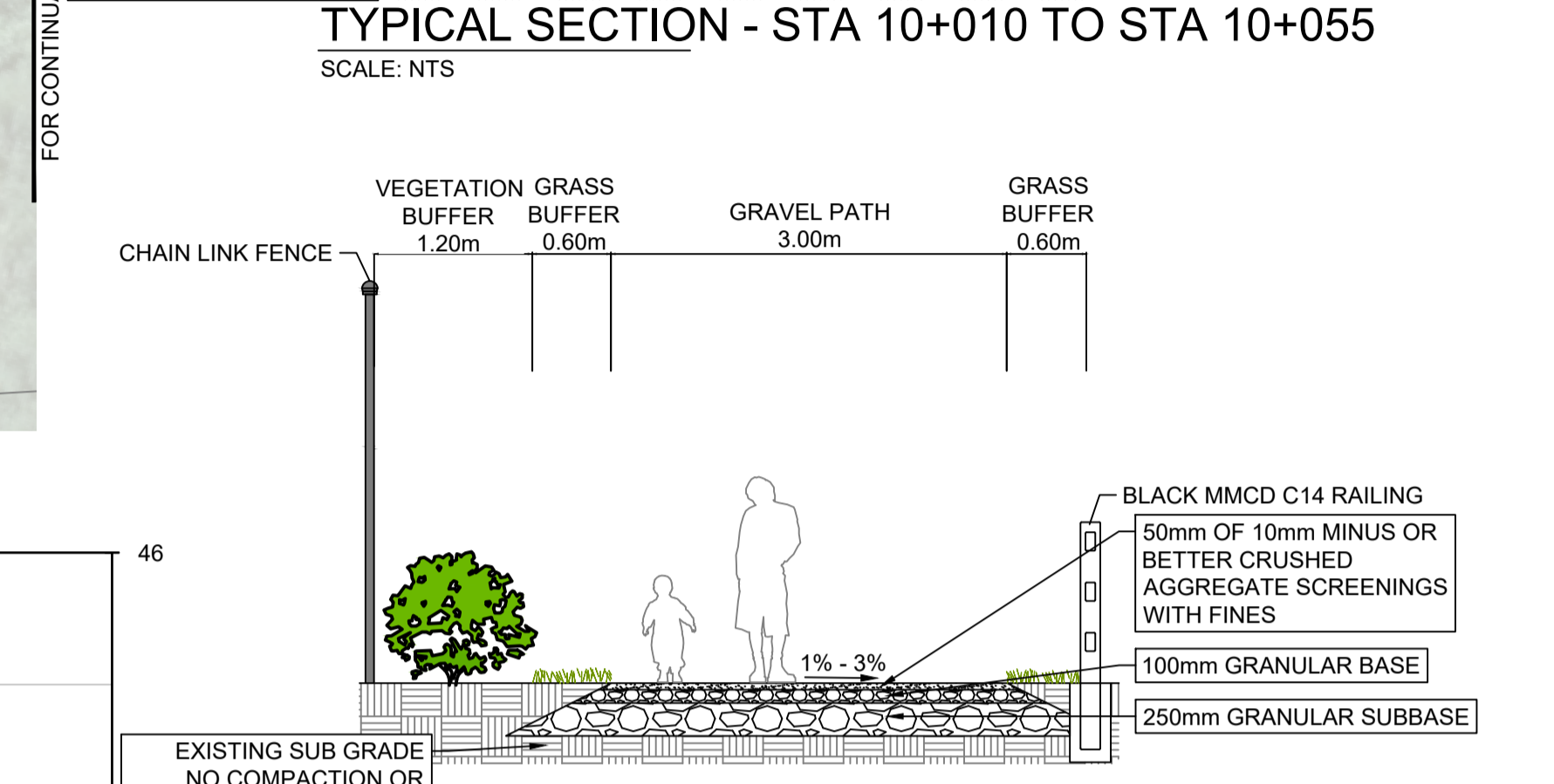
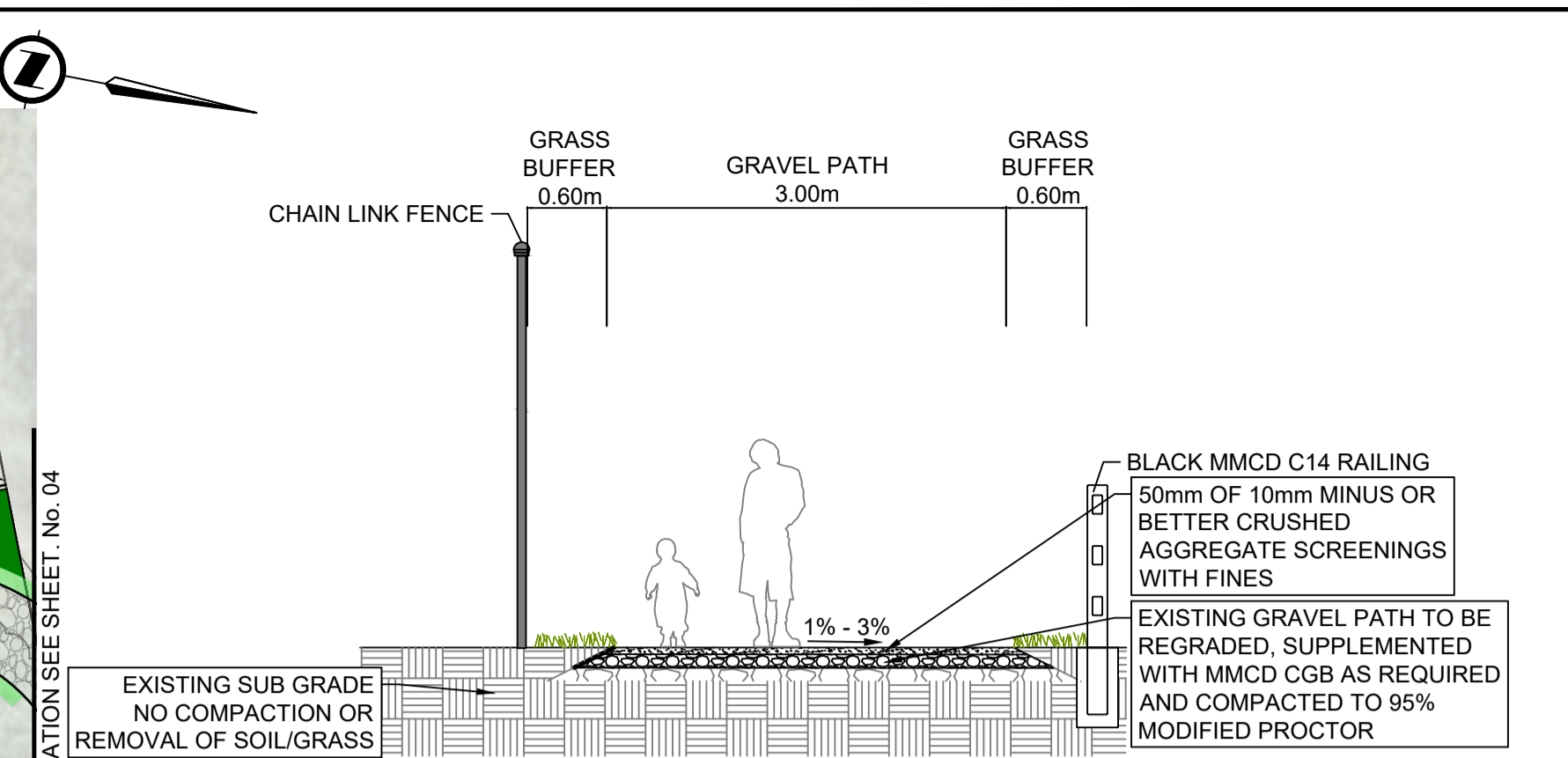
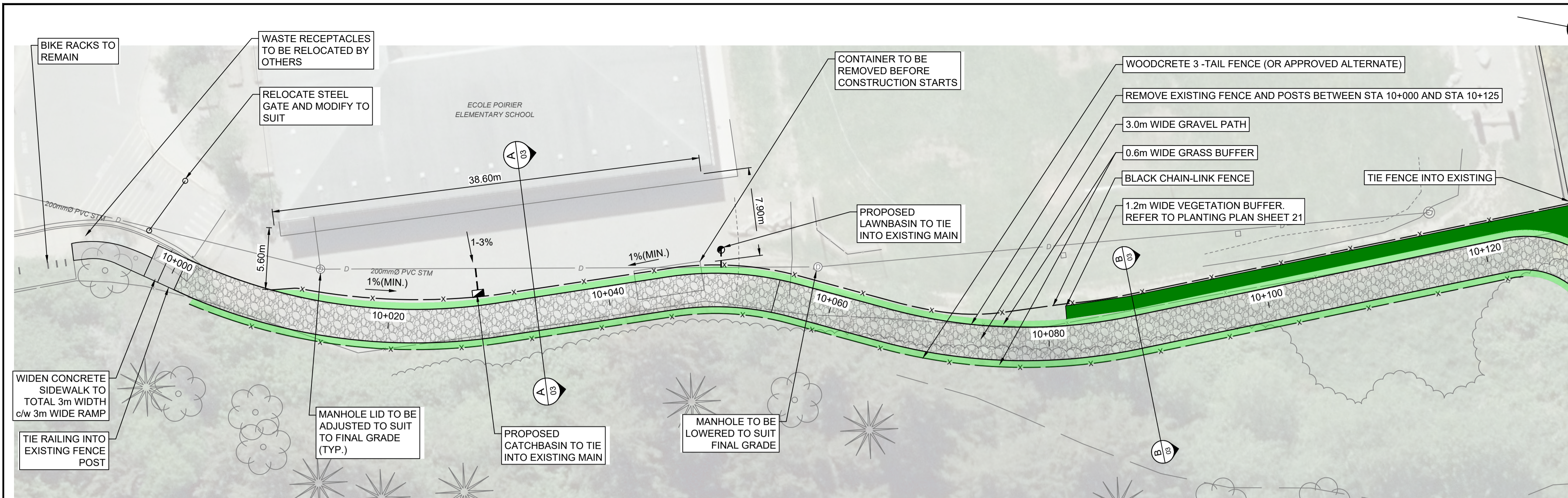

**TREATMENT LEGEND**

- PROPOSED ASPHALT
- CONCRETE
- PROPOSED GRAVEL
- PROPOSED GRASS BUFFER
- PROPOSED VEGETATION BUFFER

REFER TO PLANTING PLAN SHEET 21 FOR LANDSCAPING DETAILS

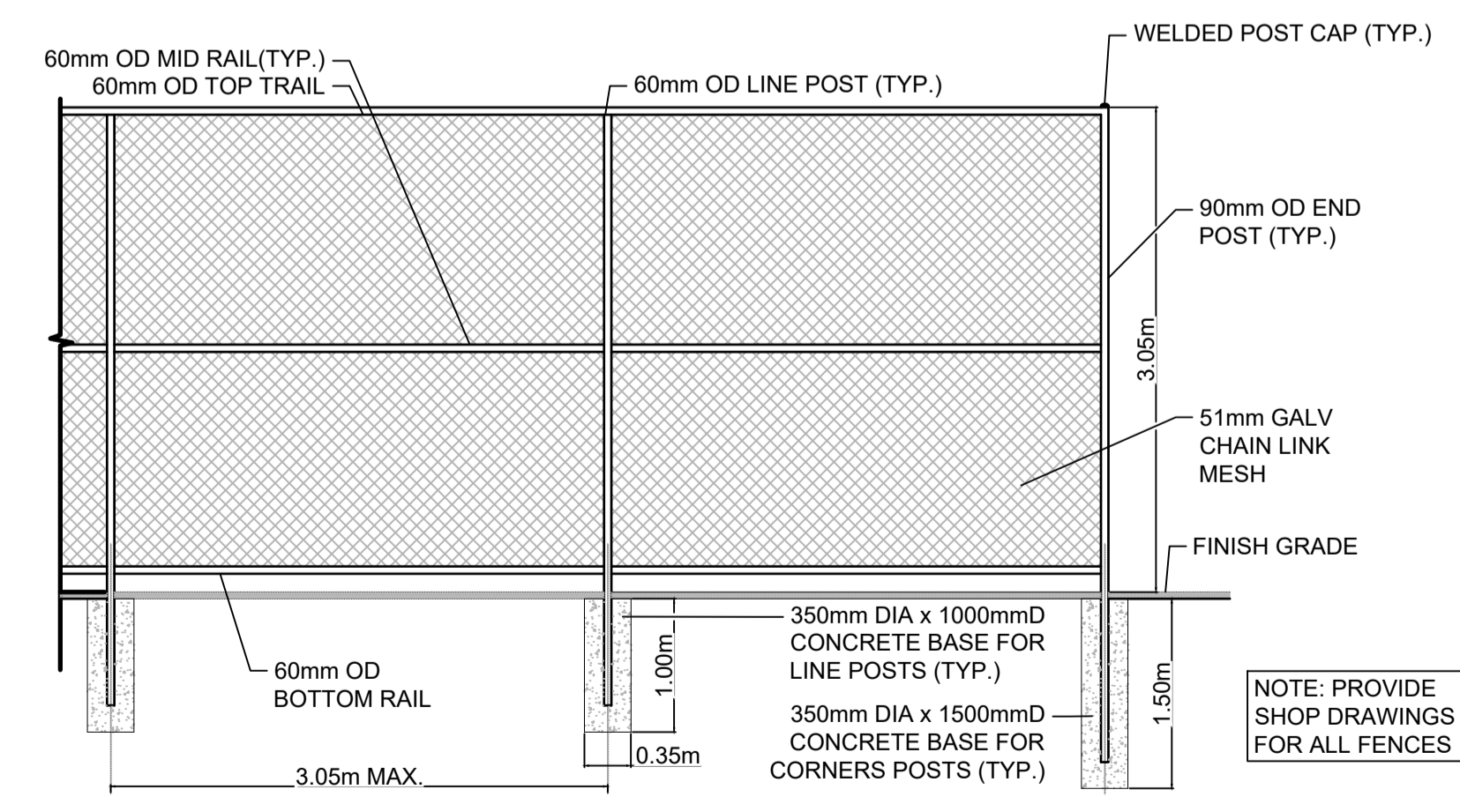
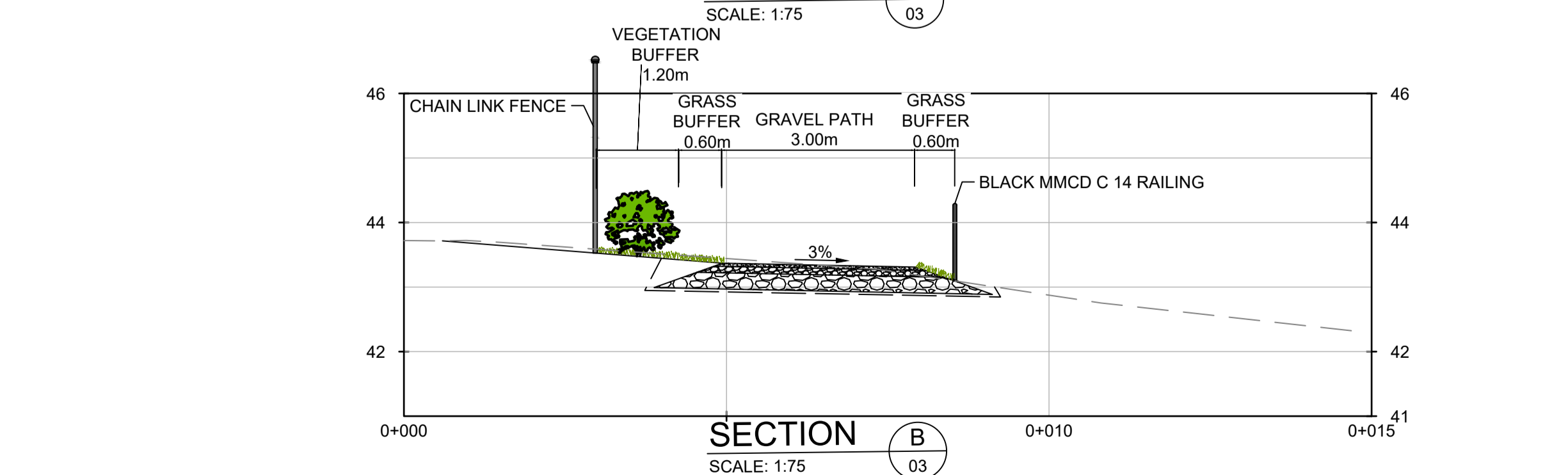
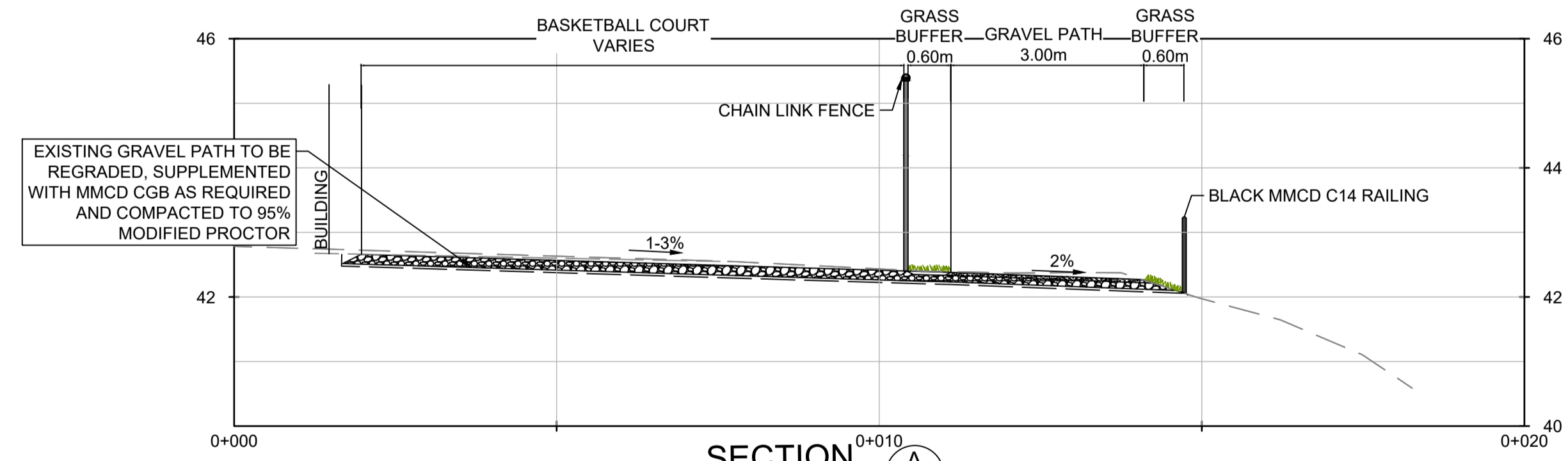
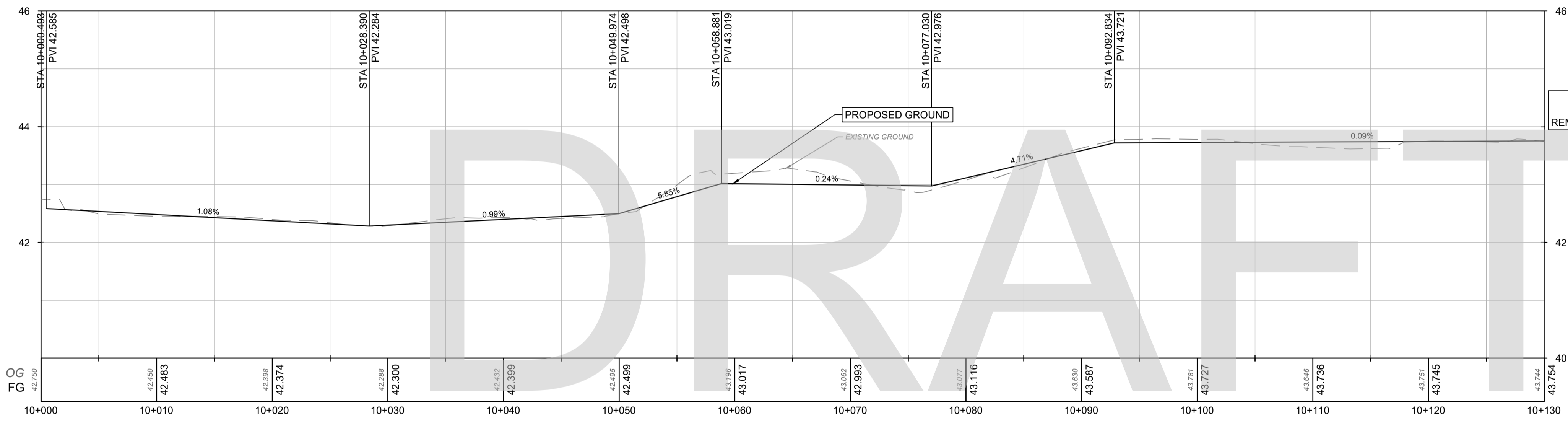

File: G:\Projects\3300033549\_DOS\_Little\_River\_Fed\_Crossing\02\_CADD\02\_Drafting\02\_CADD\02\_Production\33549\_SH\_ROADWORK.dwg

PLOT DATE: April 8, 2024

REV NO.	REVISION DESCRIPTION	DATE	DRAWN	APPRD
A	ISSUED FOR REGULATORY APPROVAL	2023.12.13	AA	IM
B	DETAILED DESIGN	2024.02.16	AA	IM
C	ISSUED FOR DISCUSSION	2024.04.08	AA	IM

**LITTLE RIVER MULTI-USE TRAIL**  
STA 10+000 TO STA 10+130



ISSUED FOR DISCUSSION DESIGN NO.

**33549**

SCALE	1:250	CREATION DATE	2023/03/01	DWG. NO.
DRAWN BY	AA	DESIGN BY	AA	03
CHECKED BY	KJ	APPROVED BY	IM	OF 21
				REV. C



**TREATMENT LEGEND**

- PROPOSED ASPHALT
- CONCRETE
- PROPOSED GRAVEL
- PROPOSED GRASS BUFFER
- PROPOSED VEGETATION BUFFER

REFER TO PLANTING PLAN SHEET 21 FOR LANDSCAPING DETAILS

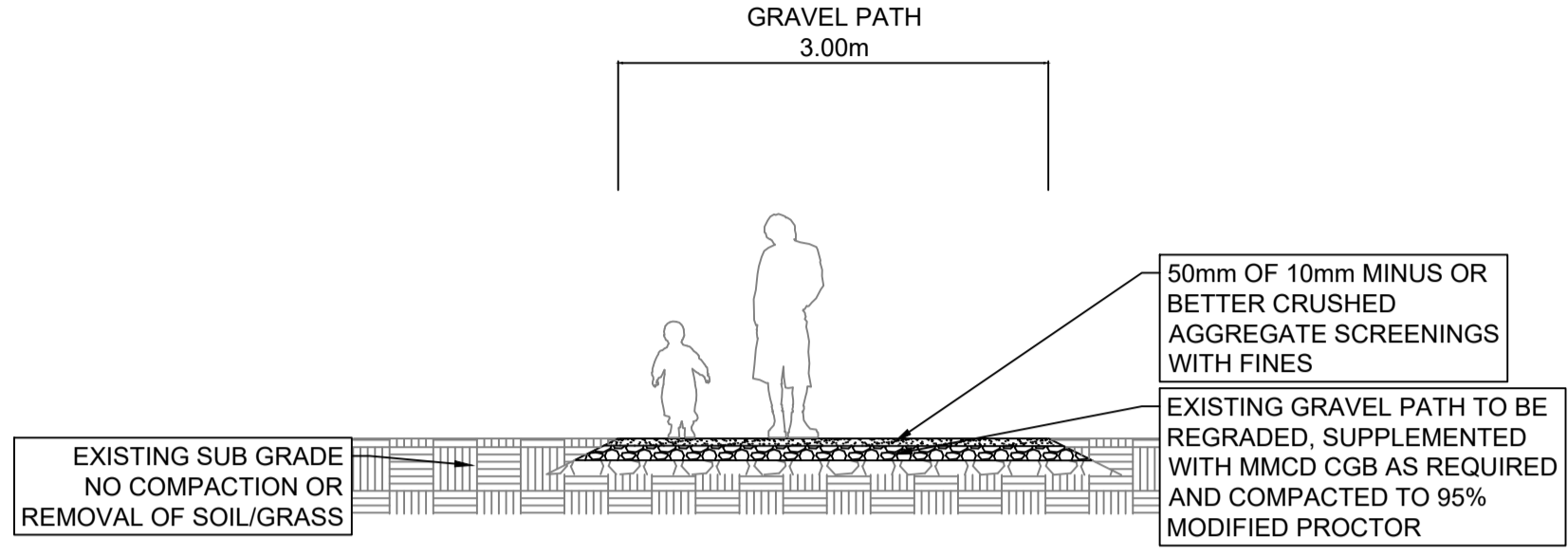

**TYPICAL SECTION - STA 10+130 TO STA 10+765**  
SCALE: NTS

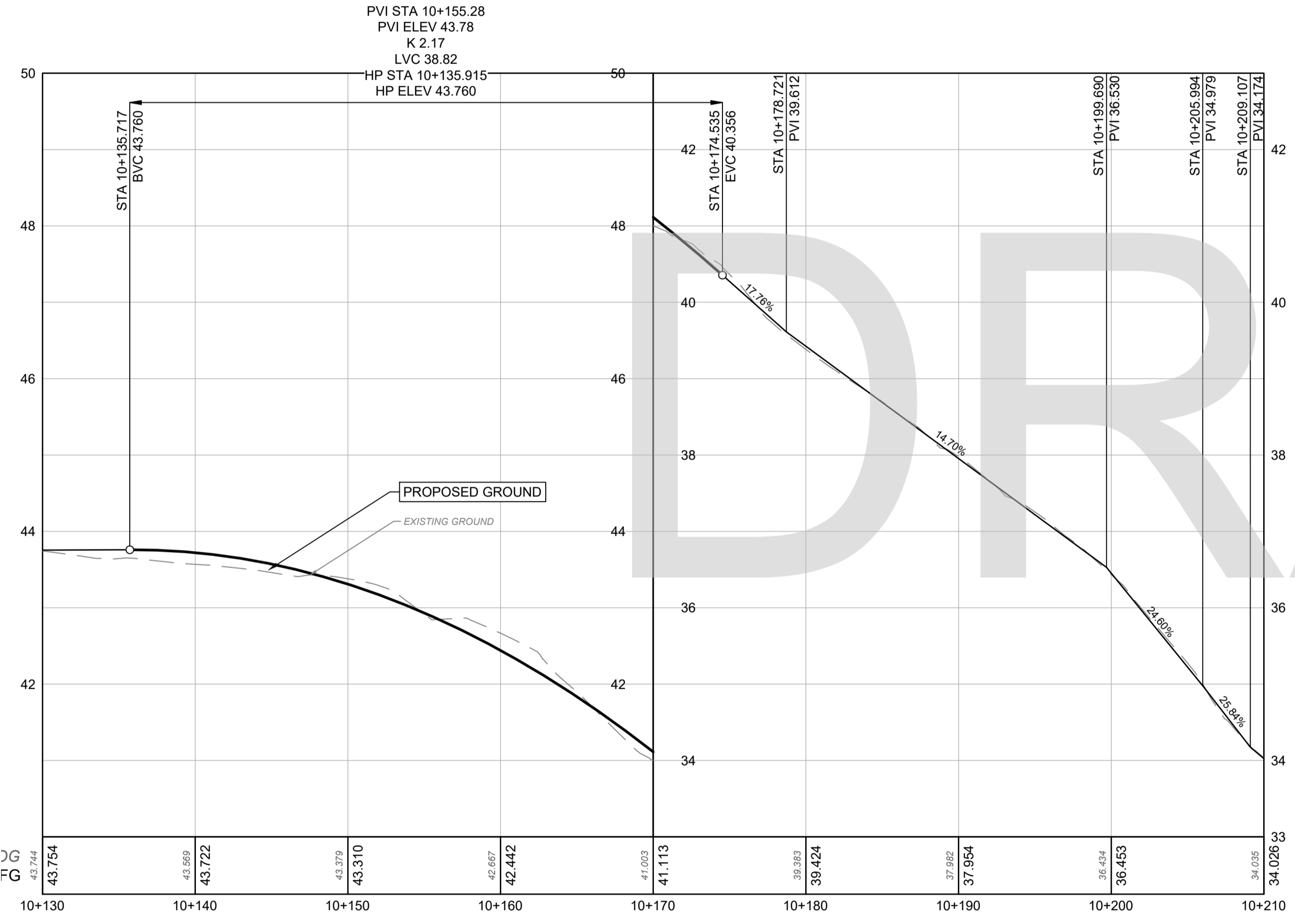

DRAFT

File: G:\Projects\33000\33000\33549\_DOS\_Little\_River\_Ped\_Crossing\02\_CADD\02\_Drafting\02\_Production\33549\_SH\_ROW\DWG\ORK.dwg

PLOT DATE: April 8, 2024

REV NO.	REVISION DESCRIPTION	DATE	DRAWN	APPRD
A	ISSUED FOR REGULATORY APPROVAL	2023.12.13	AA	IM
B	DETAILED DESIGN	2024.02.16	AA	IM
C	ISSUED FOR DISCUSSION	2024.04.08	AA	IM



**LITTLE RIVER MULTI-USE TRAIL**  
STA 10+130 TO STA 10+210



ISSUED FOR DISCUSSION DESIGN NO.

SCALE	1:250	CREATION DATE	2023/03/01	DWG. NO.
DRAWN BY	AA	DESIGN BY	AA	04 OF 21
CHECKED BY	KJ	APPROVED BY	IM	REV. C

33549

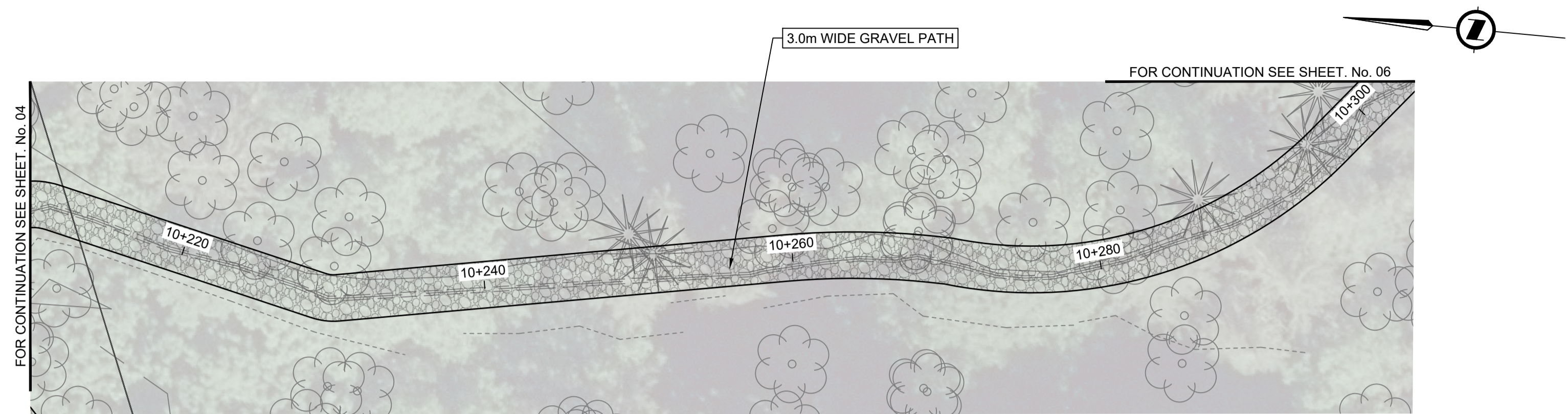

### TREATMENT LEGEND

- PROPOSED ASPHALT
- CONCRETE
- PROPOSED GRAVEL
- PROPOSED GRASS BUFFER
- PROPOSED VEGETATION BUFFER

REFER TO PLANTING PLAN SHEET 21 FOR LANDSCAPING DETAILS

PVI STA 10+251.11  
PVI ELEV 25.65  
K 0.72  
LVC 10.48  
HP STA 10+245.874  
HP ELEV 26.838

STA 10+245.874  
BVC 26.838

STA 10+256.353  
EVC 23.697

PVI STA 10+290.67  
PVI ELEV 14.11  
K 0.67  
LVC 8.93  
LP STA 10+295.185  
LP ELEV 13.680

STA 10+286.267  
BVC 15.113

STA 10+295.185  
EVC 13.680

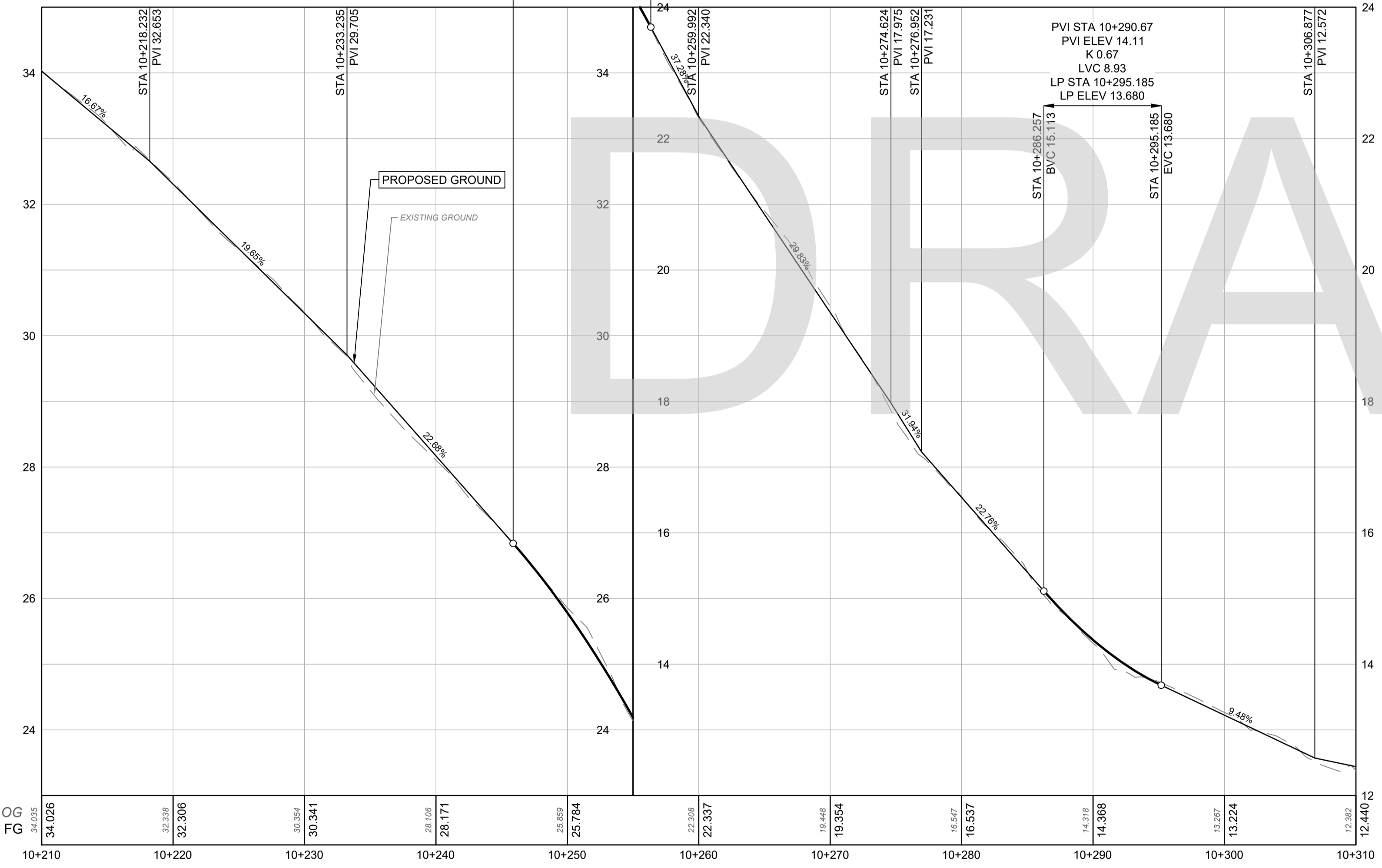

DRAFT

PLOT DATE: April 8, 2024

REV NO.	REVISION DESCRIPTION	DATE	DRAWN	APPRD
A	ISSUED FOR REGULATORY APPROVAL	2023.12.13	AA	IM
B	DETAILED DESIGN	2024.02.16	AA	IM
C	ISSUED FOR DISCUSSION	2024.04.08	AA	IM

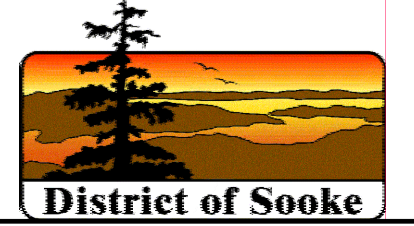

## LITTLE RIVER MULTI-USE TRAIL

### STA 10+210 TO STA 10+310



ISSUED FOR DISCUSSION DESIGN NO.

# 33549

SCALE	1:250	CREATION DATE	2023/03/01	DWG. NO.
DRAWN BY	AA	DESIGN BY	AA	05
CHECKED BY	KJ	APPROVED BY	IM	OF 21
				REV. C

File: G:\Projects\33000\33549\03\03\33549\_DOS\_Little\_River\_Multi\_Use\_Trail\_Crossing02\_CADD\02\_Production\33549\_SH\_ROADWORK.dwg

FOR CONTINUATION SEE SHEET. No. 05

FOR CONTINUATION SEE SHEET. No. 07

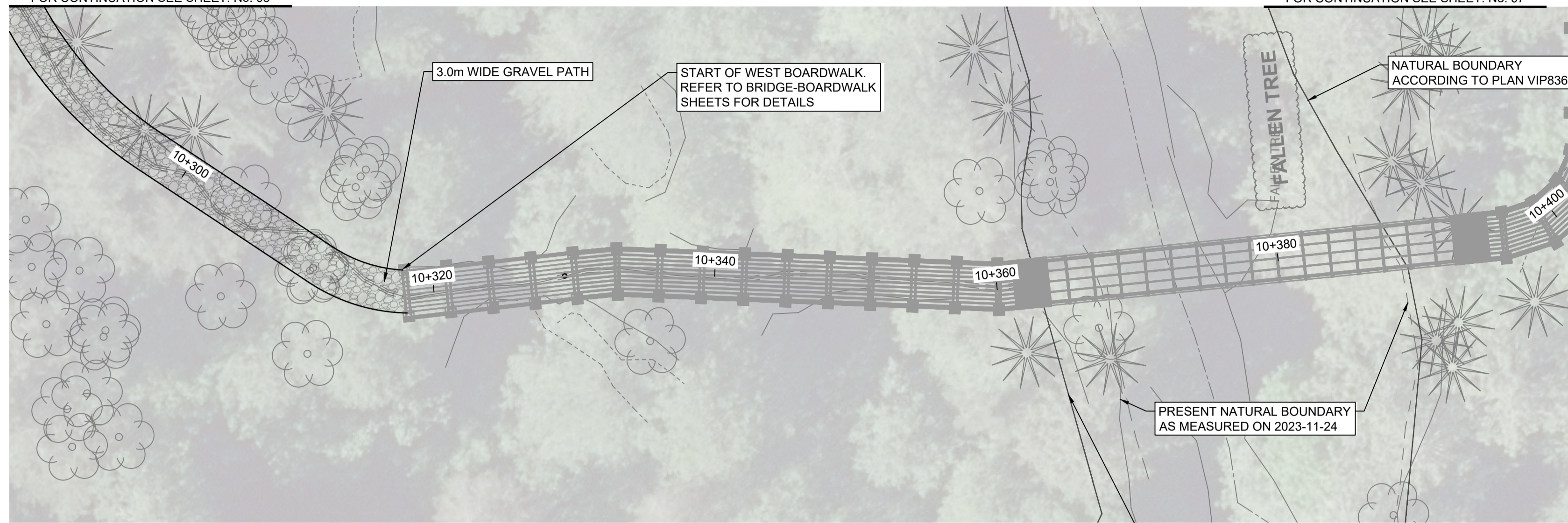

**TREATMENT LEGEND**

- PROPOSED ASPHALT
- CONCRETE
- PROPOSED GRAVEL
- PROPOSED GRASS BUFFER
- PROPOSED VEGETATION BUFFER

REFER TO PLANTING PLAN SHEET 21 FOR LANDSCAPING DETAILS

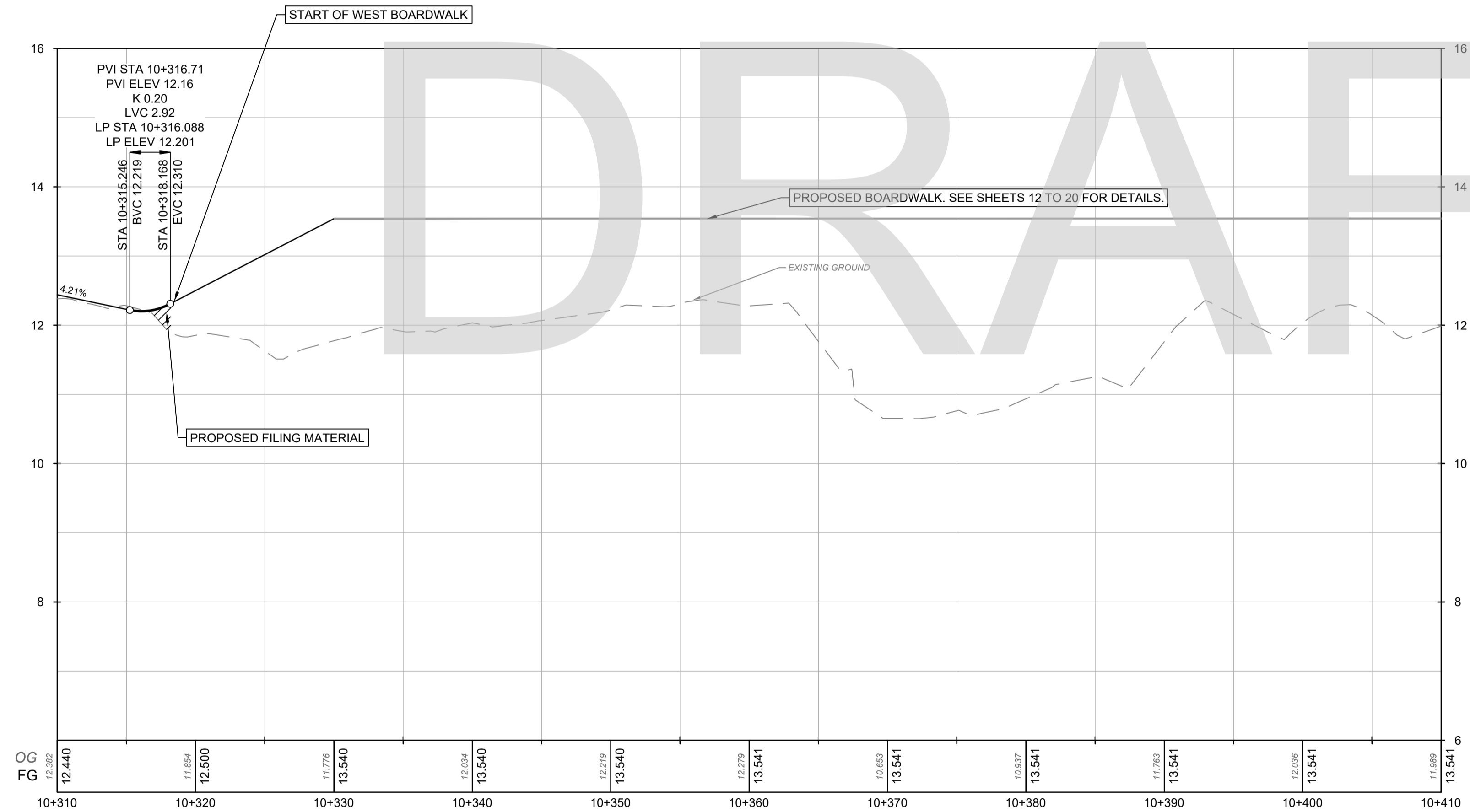

File: G:\Projects\3300\3350\33549\_DOS\_Little\_River\_Ped\_Crossing\02\_Drafting\02\_Production\33549\_SH\_ROADWORK.dwg

PLOT DATE: April 8, 2024

REV NO	REVISION DESCRIPTION	DATE	DRAWN	APPRD
A	ISSUED FOR REGULATORY APPROVAL	2023.12.13	AA	IM
B	DETAILED DESIGN	2024.02.16	AA	IM
C	ISSUED FOR DISCUSSION	2024.04.08	AA	IM

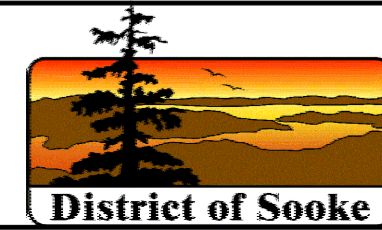

LITTLE RIVER MULTI-USE TRAIL  
STA 10+310 TO STA 10+410



1051 Vancouver St, Victoria, BC V8V 3K3  
T: (250)361-0230 F: (604)929-0756

ISSUED FOR DISCUSSION  
DESIGN NO.

33549

SCALE	1:250	CREATION DATE	2023/03/01	DWG. NO.
DRAWN BY	AA	DESIGN BY	AA	06
CHECKED BY	KJ	APPROVED BY	IM	21
				REV. C

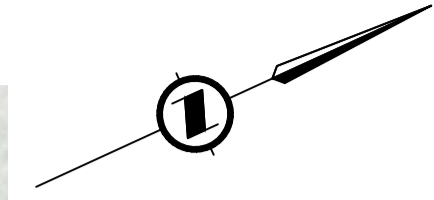
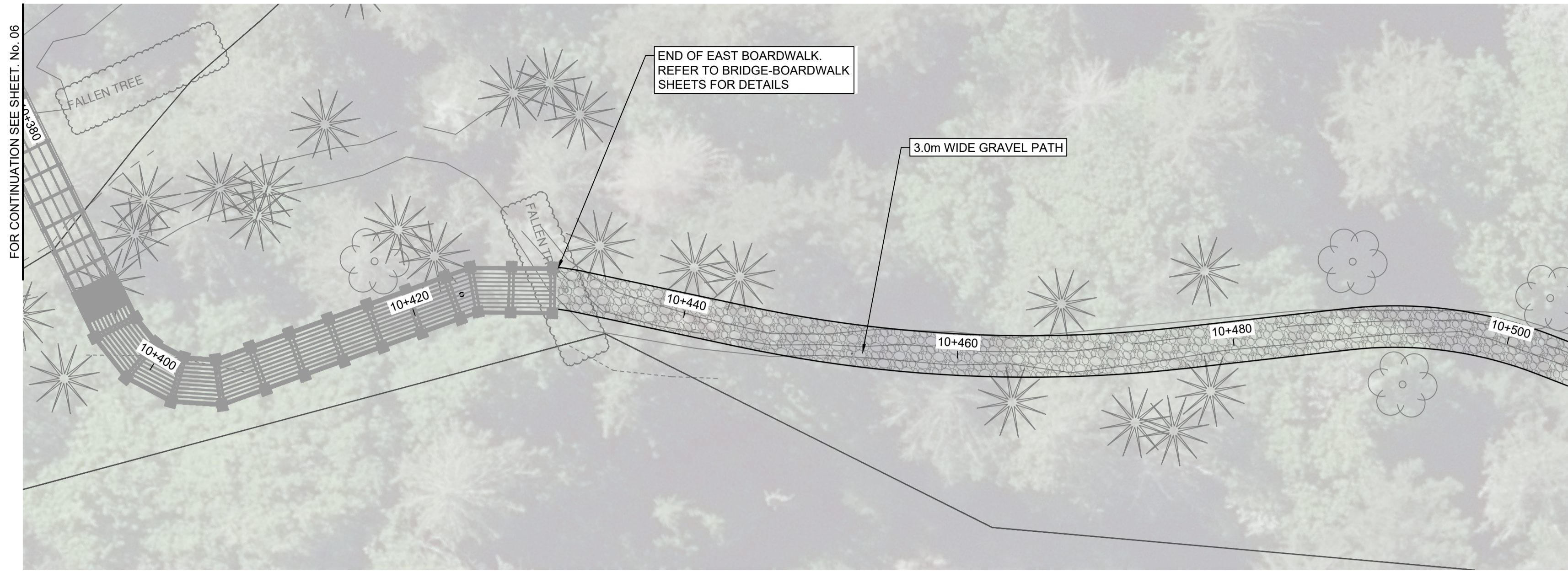

TREATMENT LEGEND	
	PROPOSED ASPHALT
	CONCRETE
	PROPOSED GRAVEL
	PROPOSED GRASS BUFFER
	PROPOSED VEGETATION BUFFER

REFER TO PLANTING PLAN SHEET 21 FOR LANDSCAPING DETAILS

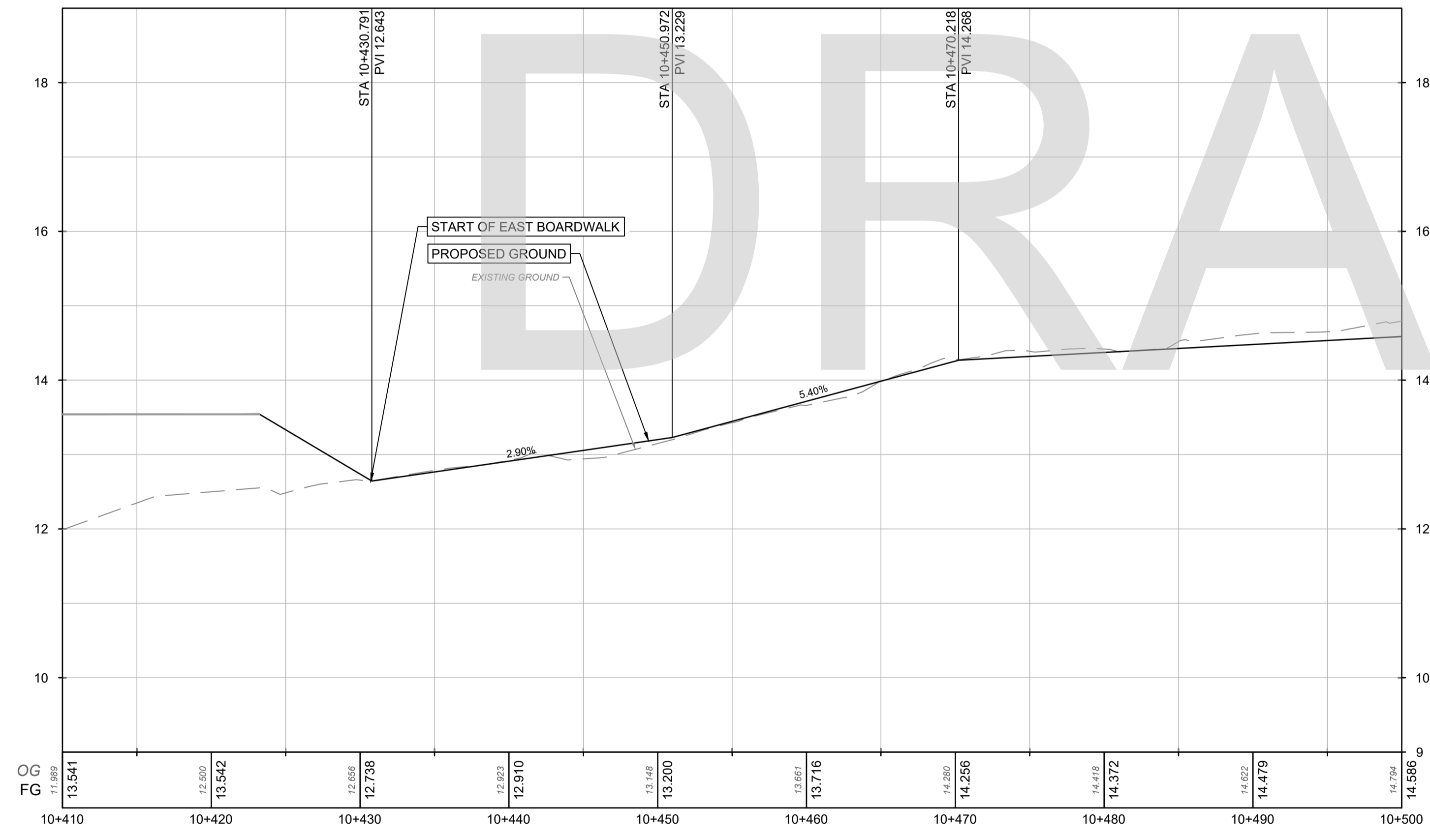

DRAFT

File: G:\Projects\3300\3350\033549\_DOS\_Little\_River\_Ped\_Crossing\02\_CADD\02\_Production\33549\_SH\_ROADWORK.dwg

PLOT DATE: April 8, 2024

REV NO.	REVISION DESCRIPTION	DATE	DRAWN	APPRD
A	ISSUED FOR REGULATORY APPROVAL	2023.12.13	AA	IM
B	DETAILED DESIGN	2024.02.16	AA	IM
C	ISSUED FOR DISCUSSION	2024.04.08	AA	IM

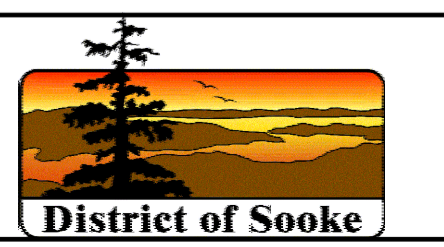

**LITTLE RIVER MULTI-USE TRAIL**  
STA 10+410 TO STA 10+500



ISSUED FOR DISCUSSION DESIGN NO.

33549

SCALE	1:250	CREATION DATE	2023/03/01	DWG. NO.
DRAWN BY	AA	DESIGN BY	AA	07
CHECKED BY	KJ	APPROVED BY	IM	21
				REV. C

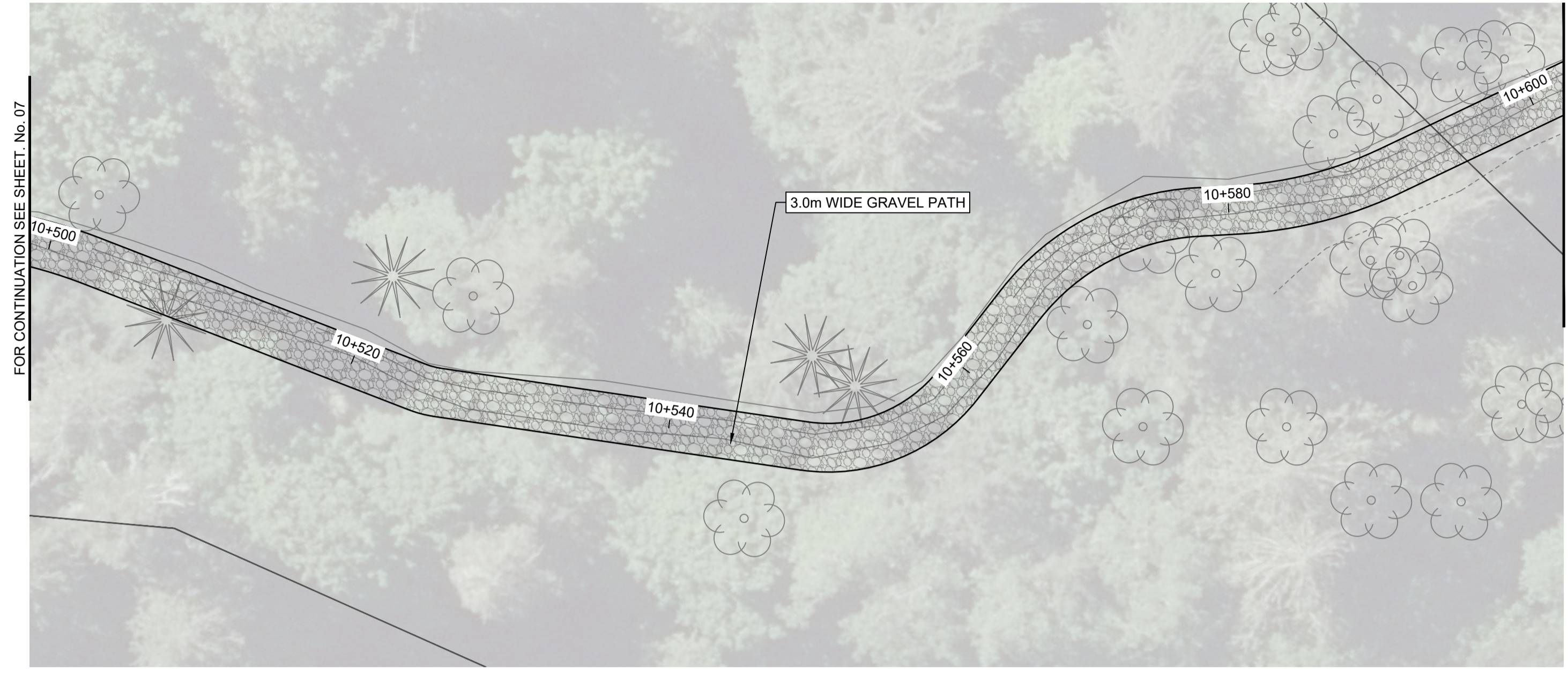

**TREATMENT LEGEND**

- PROPOSED ASPHALT
- CONCRETE
- PROPOSED GRAVEL
- PROPOSED GRASS BUFFER
- PROPOSED VEGETATION BUFFER

REFER TO PLANTING PLAN SHEET 21 FOR LANDSCAPING DETAILS

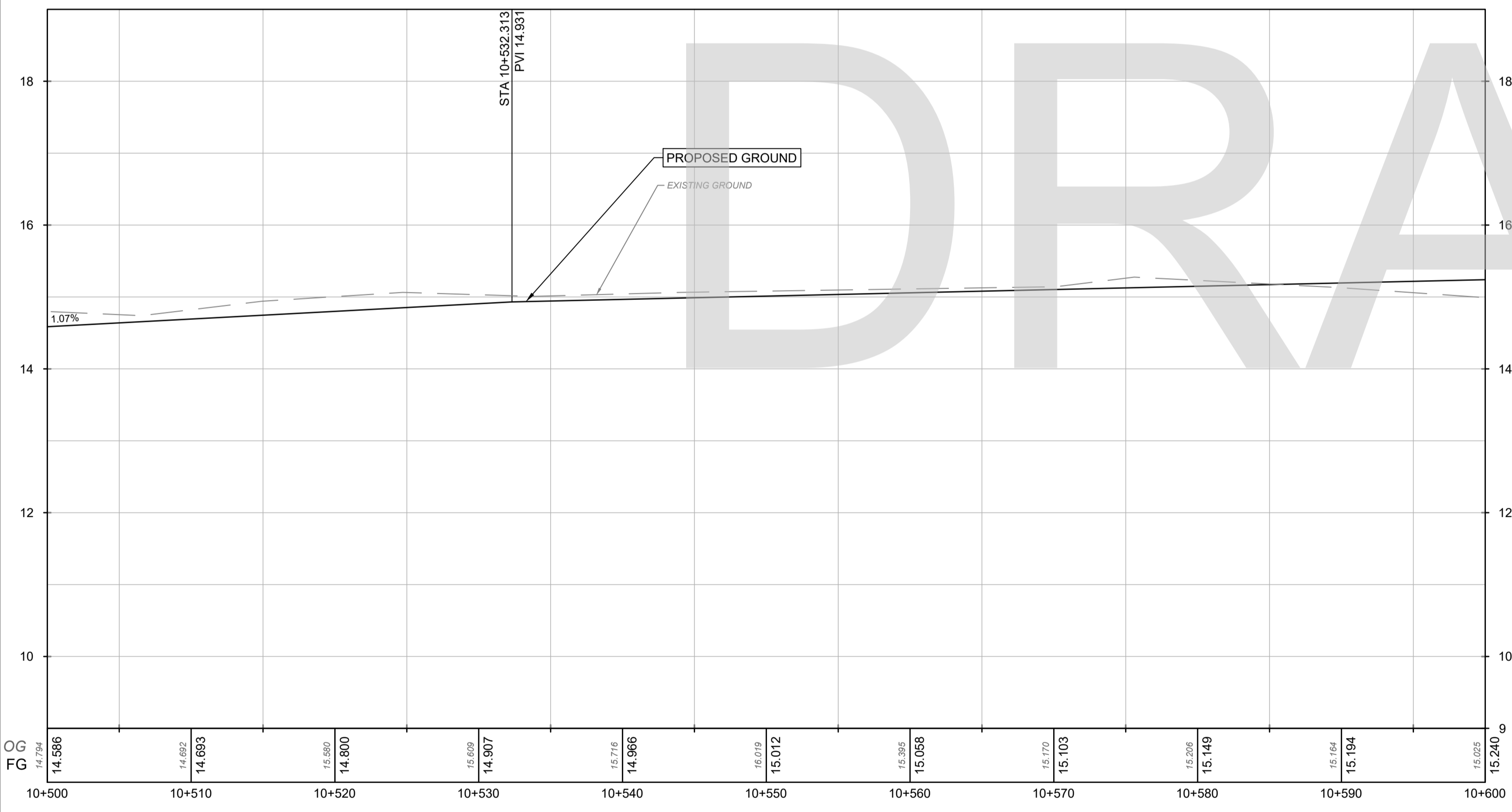

G:\Projects\33549\33549\_DOS\_Little\_River\_Ped\_Crossing\02\_CADD\02\_Drafting\02\_Production\33549\_SH\_ROAD\WORK.dwg  
 PLOT DATE: April 8, 2024

REV NO.	REVISION DESCRIPTION	DATE	DRAWN	APPRD
A	ISSUED FOR REGULATORY APPROVAL	2023.12.13	AA	IM
B	DETAILED DESIGN	2024.02.16	AA	IM
C	ISSUED FOR DISCUSSION	2024.04.08	AA	IM

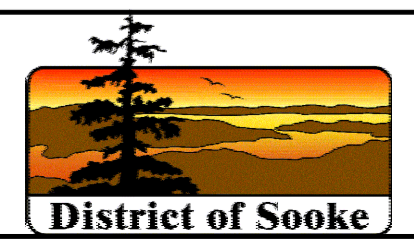

**LITTLE RIVER MULTI-USE TRAIL**  
 STA 10+500 TO STA 10+600



ISSUED FOR DISCUSSION DESIGN NO.

SCALE	1:250	CREATION DATE	2023/03/01	DWG. NO.
DRAWN BY	AA	DESIGN BY	AA	08
CHECKED BY	KJ	APPROVED BY	IM	21
				REV. C

**33549**



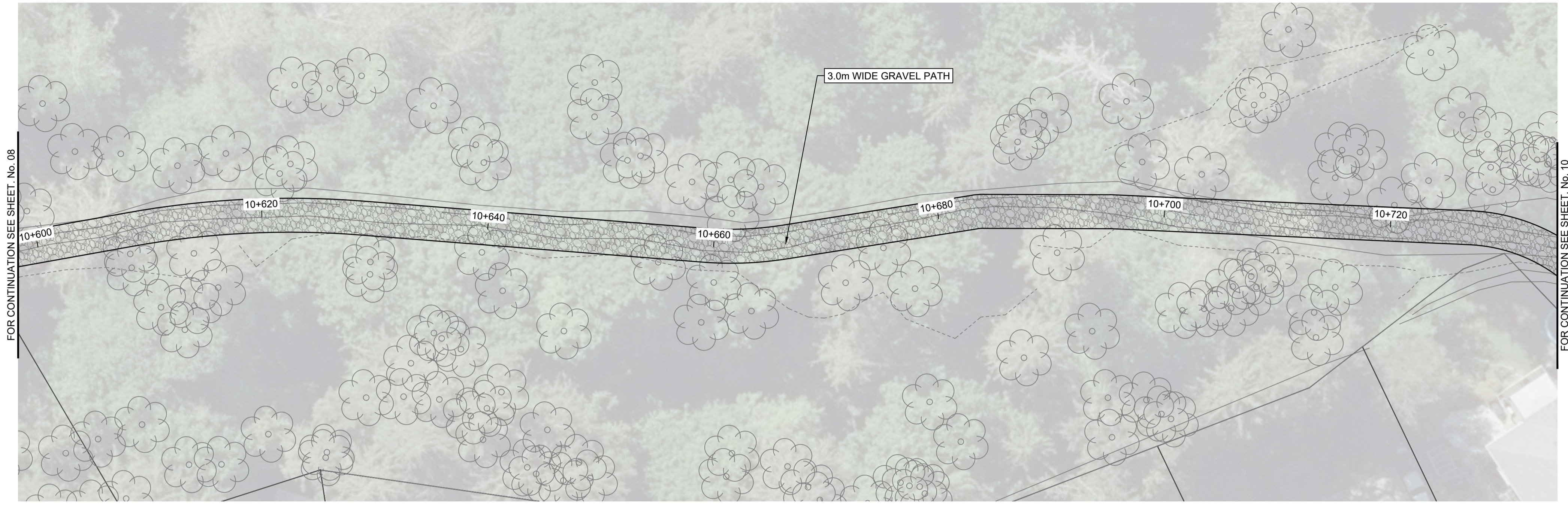
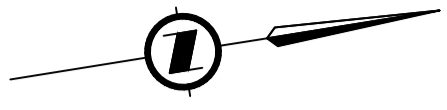

**TREATMENT LEGEND**

- PROPOSED ASPHALT
- CONCRETE
- PROPOSED GRAVEL
- PROPOSED GRASS BUFFER
- PROPOSED VEGETATION BUFFER

REFER TO PLANTING PLAN SHEET 21 FOR LANDSCAPING DETAILS

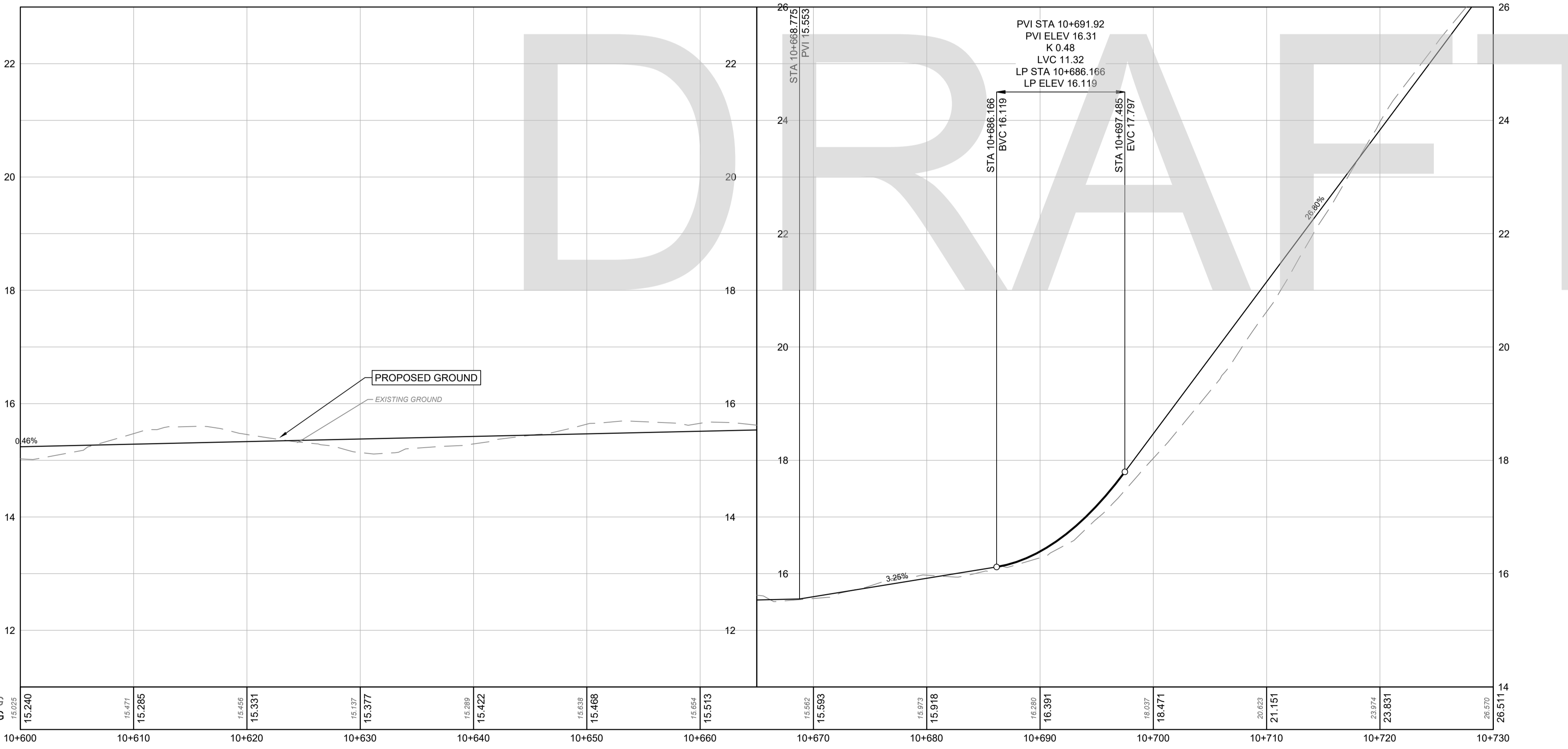

G:\Projects\3300\3300\3300\33549\_DOS\_Little\_River\_Fed\_Crossing\02\_Drafting\02\_Productions\33549\_SH\_ROADWORK.dwg

PLOT DATE: April 8, 2024

REV NO.	REVISION DESCRIPTION	DATE	DRAWN	APPRD
A	ISSUED FOR REGULATORY APPROVAL	2023.12.13	AA	IM
B	DETAILED DESIGN	2024.02.16	AA	IM
C	ISSUED FOR DISCUSSION	2024.04.08	AA	IM

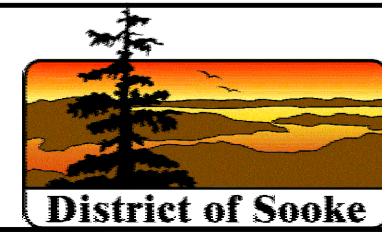

**LITTLE RIVER MULTI-USE TRAIL**  
STA 10+600 TO STA 10+730



1051 Vancouver St, Victoria, BC V8V 3K3  
T: (250)361-3230 F: (250)361-3756

ISSUED FOR DISCUSSION DESIGN NO.

**33549**

SCALE	1:250	CREATION DATE	2023/03/01	DWG NO.
DRAWN BY	AA	DESIGN BY	AA	09
CHECKED BY	KJ	APPROVED BY	IM	21
				REV. C

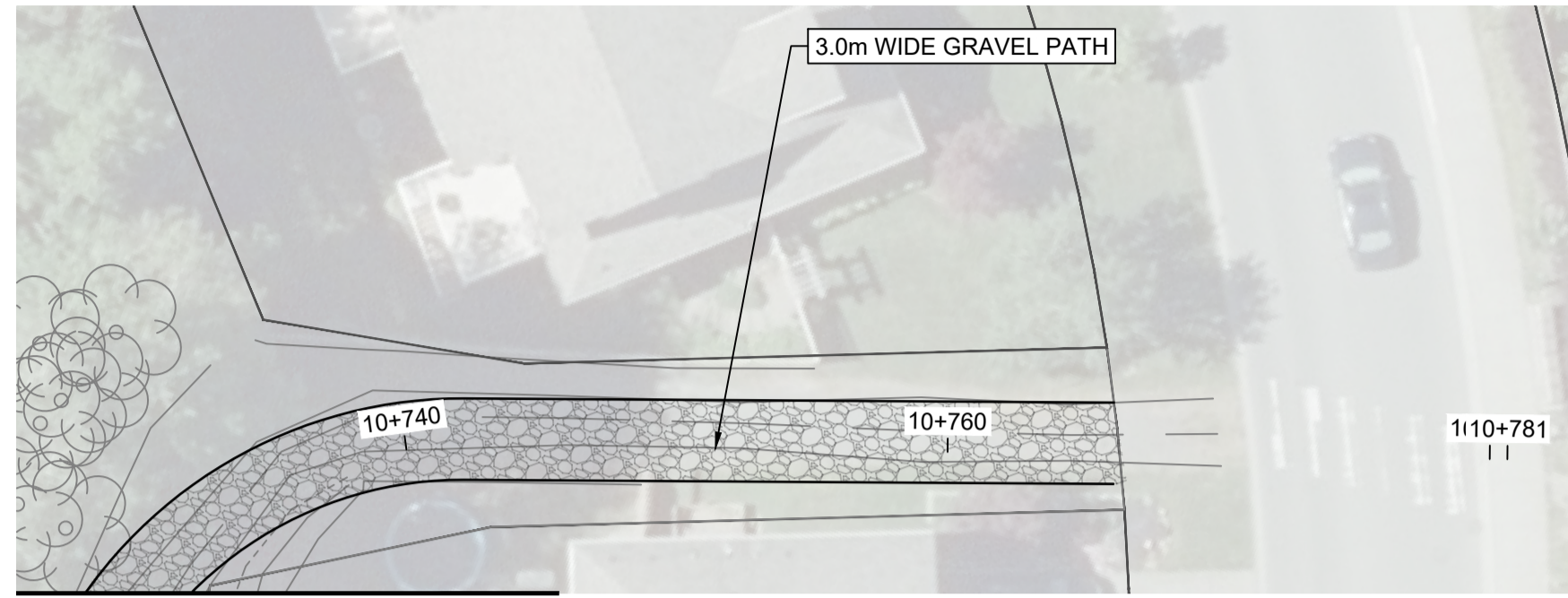

FOR CONTINUATION SEE SHEET. No. 09

TREATMENT LEGEND	
	PROPOSED ASPHALT
	CONCRETE
	PROPOSED GRAVEL
	PROPOSED GRASS BUFFER
	PROPOSED VEGETATION BUFFER

REFER TO PLANTING PLAN SHEET 21 FOR LANDSCAPING DETAILS

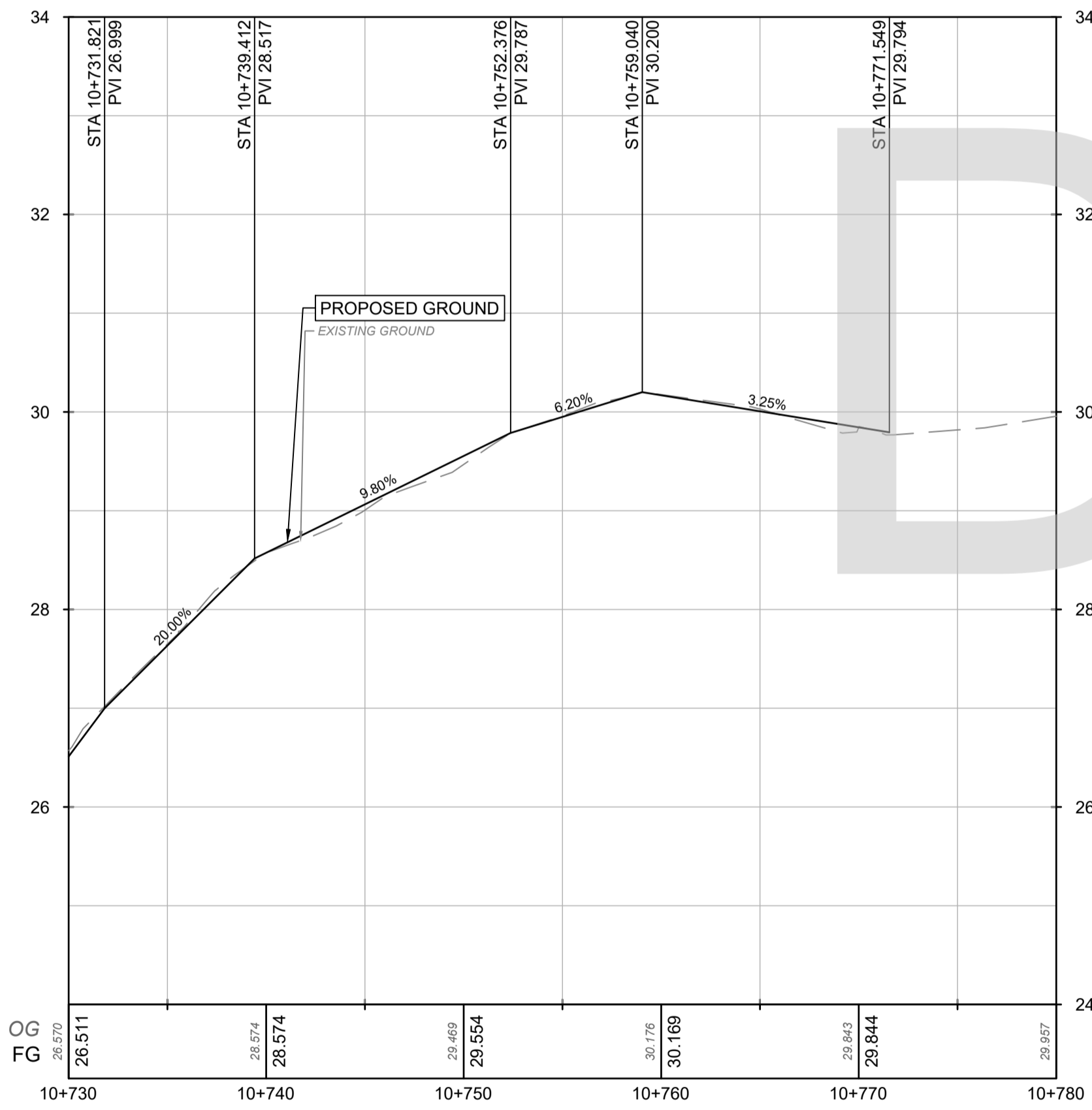

DRAFT

File: G:\Projects\33000\33500\33549\_DOS\_Little\_River\_Ped\_Crossing\02\_CADD\02\_Drafting\02\_Production\33549\_SH\_ROADWORK.dwg

PLOT DATE: April 8, 2024

REV NO.	REVISION DESCRIPTION	DATE	DRAWN	APPRD
A	ISSUED FOR REGULATORY APPROVAL	2023.12.13	AA	IM
B	DETAILED DESIGN	2024.02.16	AA	IM
C	ISSUED FOR DISCUSSION	2024.04.08	AA	IM

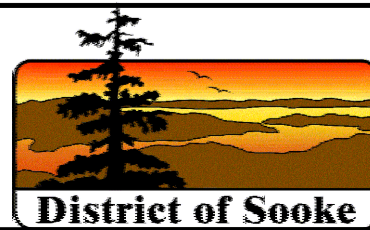

LITTLE RIVER MULTI-USE TRAIL  
STA 10+730 TO STA 10+780



1051 Vancouver St. Victoria, BC V8V 3K3  
T: (250)361-3230 F: (604)629-5756

ISSUED FOR DISCUSSION DESIGN NO.

SCALE	1:250	CREATION DATE	2023/03/01	DWG. NO.
DRAWN BY	AA	DESIGN BY	AA	10
CHECKED BY	KJ	APPROVED BY	IM	21
				REV. C

33549

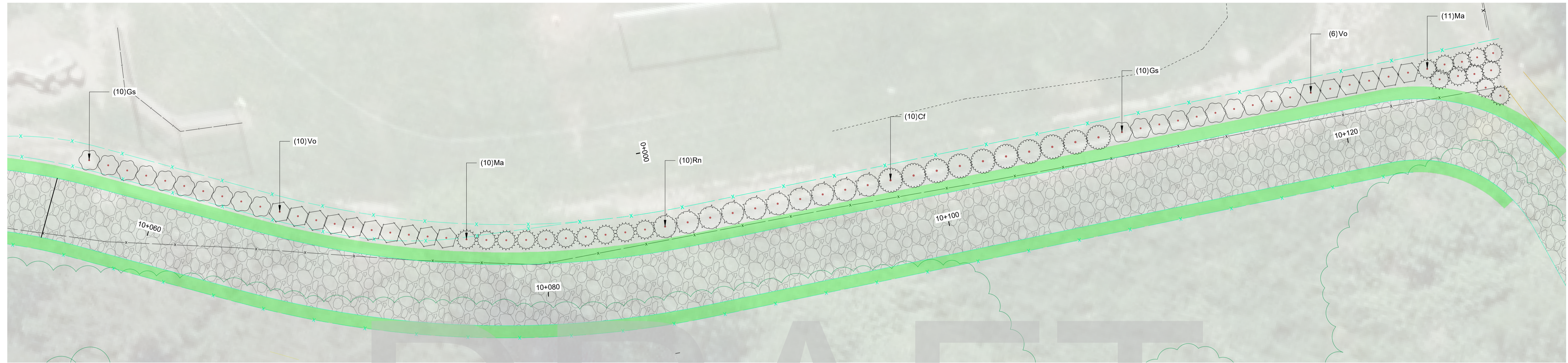
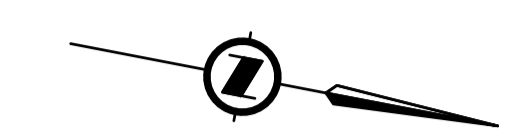

1 PLANTING PLAN  
L01 PLAN

SCALE 1:100

**PLANT SCHEDULE**

SYMBOL	CODE	QTY	BOTANICAL NAME	COMMON NAME	SIZE	SPACING
<b>SHRUBS</b>						
	Cf	10	Cornus stolonifera 'Farrow'	Arctic Fire® Red Twig Dogwood	#3 Pot	1.2 m
	Gs	20	Gaultheria shallon	Salal	#3 Pot	1 m
	Ma	21	Mahonia aquifolium	Oregon Grape	#3 Pot	1 m
	Rn	10	Rosa nutkana	Nootka Rose	#3 Pot	1.2 m
	Vo	16	Vaccinium ovatum	Evergreen Huckleberry	#3 Pot	1 m

**LANDSCAPE NOTES**

- SOFT LANDSCAPE SUPPLY, SUBMITTALS, PREPARATION AND EXECUTION TO COMPLY WITH CANADIAN LANDSCAPE STANDARD (BRITISH COLUMBIA). FULL DOCUMENT APPLIES.
- PLANTS:
  - PROVIDE CONSULTANT WITH OPPORTUNITY TO REVIEW PLANT STOCK AT NURSERY PRIOR TO SHIPMENT TO SITE. CONSULTANT RESERVES RIGHT TO REJECT STOCK ON SITE WHEN INCONSISTENT FROM NURSERY SAMPLE STOCK. ONE (1) WEEK NOTICE IS REQUIRED FOR NURSERY REVIEW.
  - PLANTS TO BE WELL-ESTABLISHED AND UNIFORM IN SIZE. ALL PLANTS TO CONFORM TO THE STANDARDS SPECIFIED IN THE LATEST EDITION OF THE CANADIAN LANDSCAPE AND NURSERY ASSOCIATION STANDARD.
  - GROWING MEDIUM AND DEPTH AS PER CONSTRUCTION DETAILS.
  - SUBMIT GROWING MEDIUM REPORT FOR REVIEW PRIOR TO ORDER OR INSTALLATION.
- MULCH:
  - TO BE COMPOSTED BARK, BROWN (NOT RED) IN COLOUR.
  - DEPTH OF MULCH TO BE 75mm AFTER SETTLEMENT WITH COMPLETE COVERAGE.
  - PROVIDE CONTINUOUS MULCH FOR SHRUB AND GROUNDCOVER BEDS SO THAT PLANTS HAVE 100% COMPLETE COVERAGE OF ROOT ZONES, COMPLETE FROM PLANT TO PLANT.
  - DO NOT BURY PLANTS WITH MULCH. KEEP MULCH AWAY FROM SHRUB STEMS AND TREE TRUNKS.
- LANDSCAPE ESTABLISHMENT MAINTENANCE AND WATERING TO TOTAL COMPLETION AS PER CANADIAN LANDSCAPE STANDARD.
- WARRANTY: THIS PROJECT REQUIRES A ONE YEAR WARRANTY ON ALL SOFTSCAPE WORK.

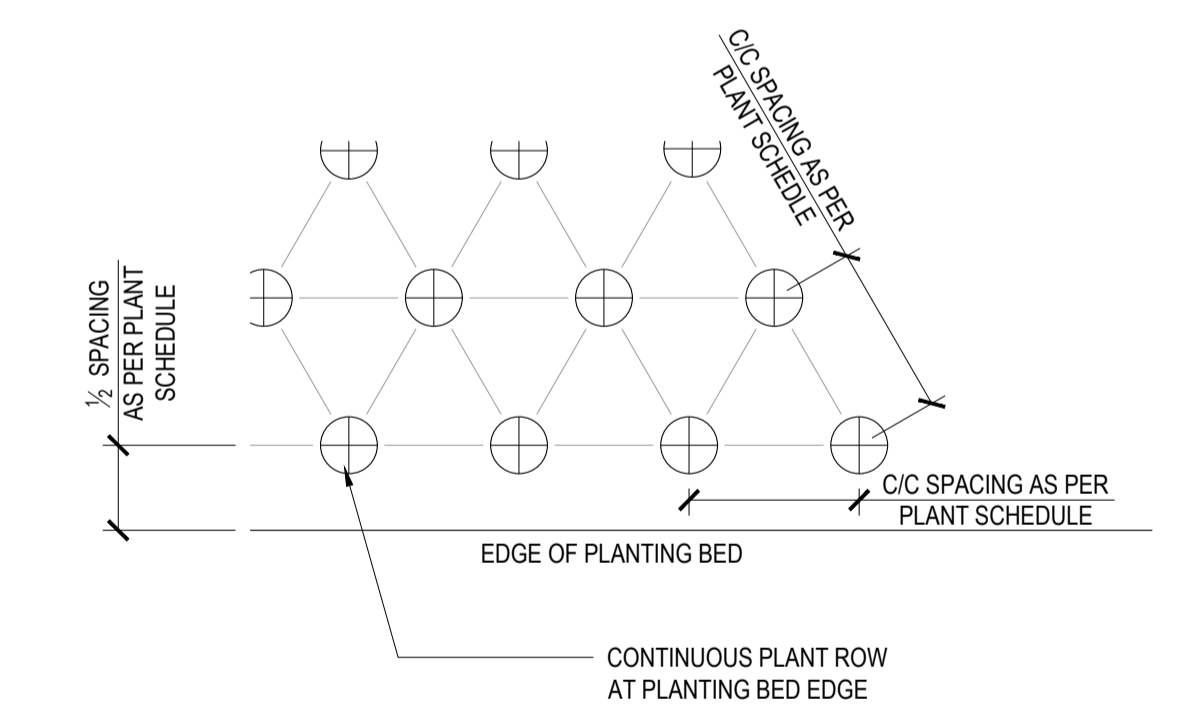
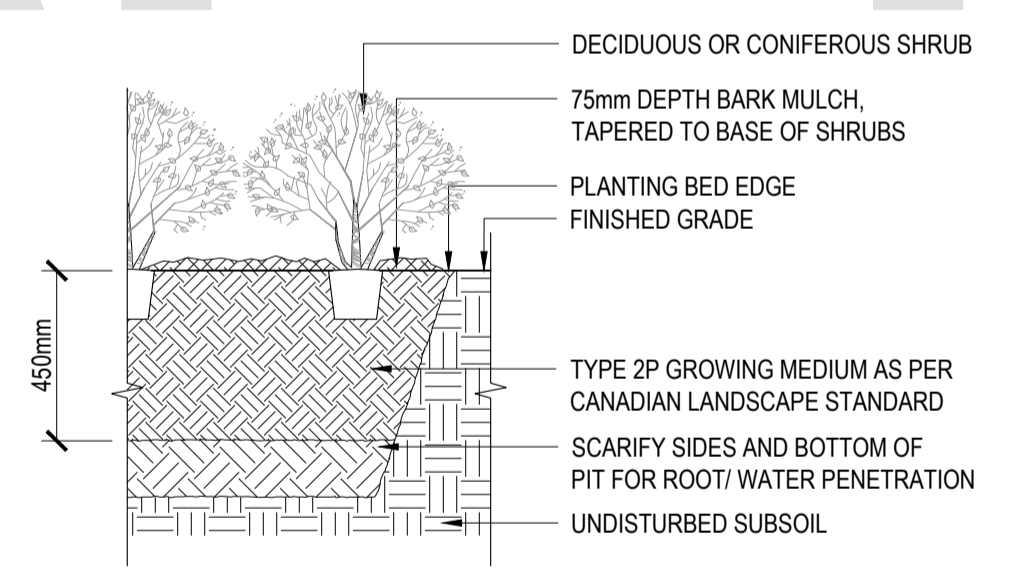

2 SHRUB PLANTING DETAIL  
L01 SECTION/PLAN

SCALE 1:100

PLOT DATE: February 20, 2024					
REV NO.	REVISION DESCRIPTION	DATE	DRAWN	APPRD	
A	ISSUED FOR REGULATORY APPROVAL	2023.12.13	AA	IM	
B	DETAILED DESIGN	2024.02.16	AA	IM	
C	ISSUED FOR DISCUSSION	2024.04.08	AA	IM	

**LITTLE RIVER MULTI-USE TRAIL  
PLANTING PLAN AND DETAIL**



ISSUED FOR DISCUSSION DESIGN NO.

**33549**

SCALE	1:250	CREATION DATE	2023/03/01	DWG. NO.	21 OF 21
DRAWN BY	AA	DESIGN BY	AA		
CHECKED BY	KJ	APPROVED BY	IM		
				REV.	C